

Drawing Class No. 7
Isometric Projections I

Question 1

Draw the isometric projection of the object shown in Figure 1 based on the three given orthographic views in THIRD ANGLE PROJECTION. All dimensions are in mm.

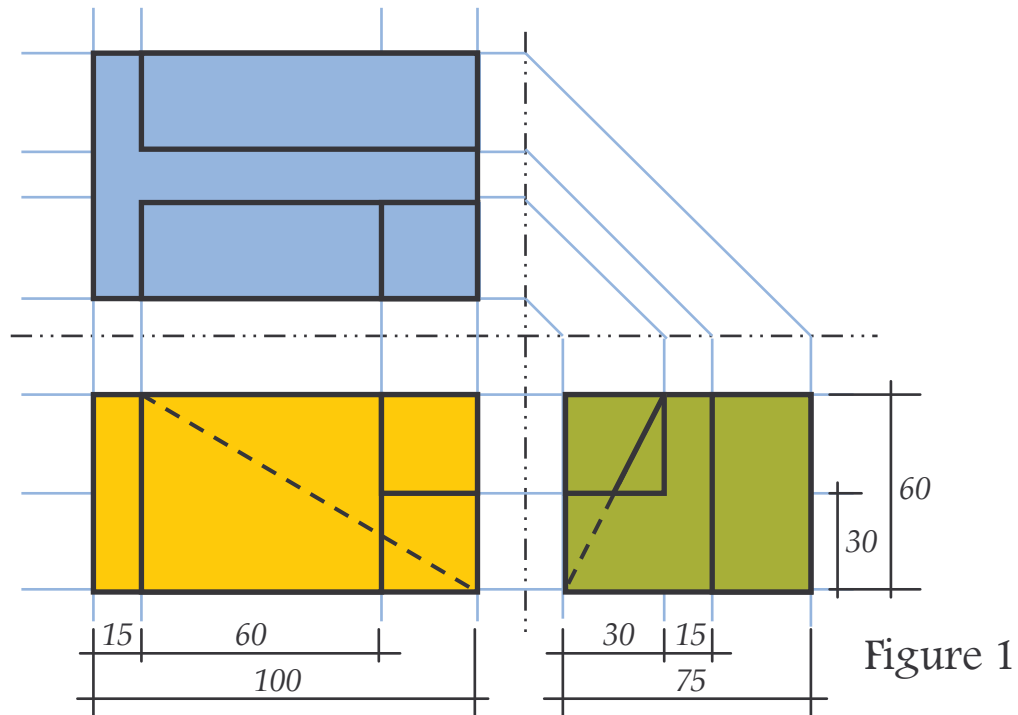

Figure 1

Question 2

Make isometric drawings of the objects shown in Figures 2 and 3 based on the top and front orthographic views. There could be multiple answers!! Use proportional dimensions.

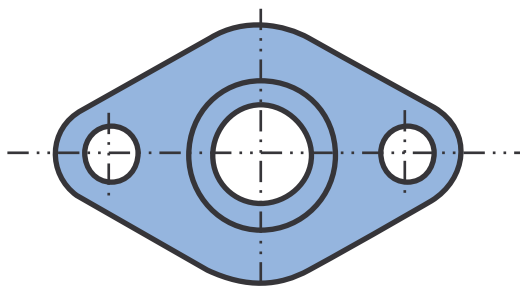

Figure 2

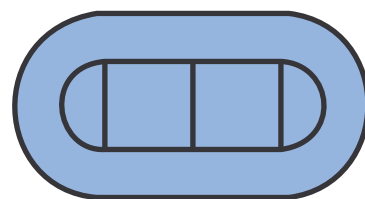

Figure 3