

Lecture 1

# BASICS OF ENGINEERING DRAWING



TA 101 : Engineering Graphics

2007-08 Semester II

January – May 2008

# SKETCHING VERSUS DRAWING

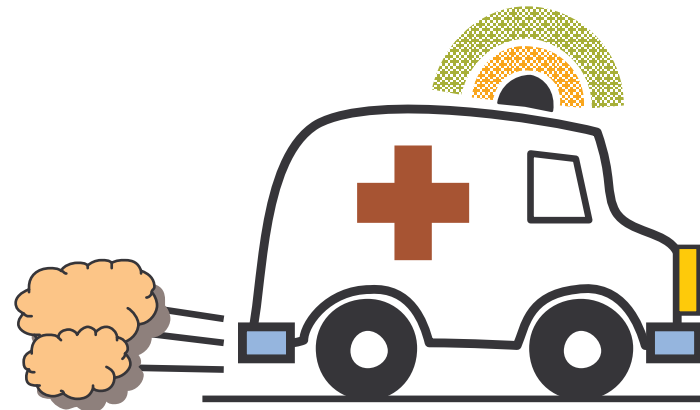

# OUTLINE

- Basics of Engineering Drawing

- Need

- Tools

- Tips

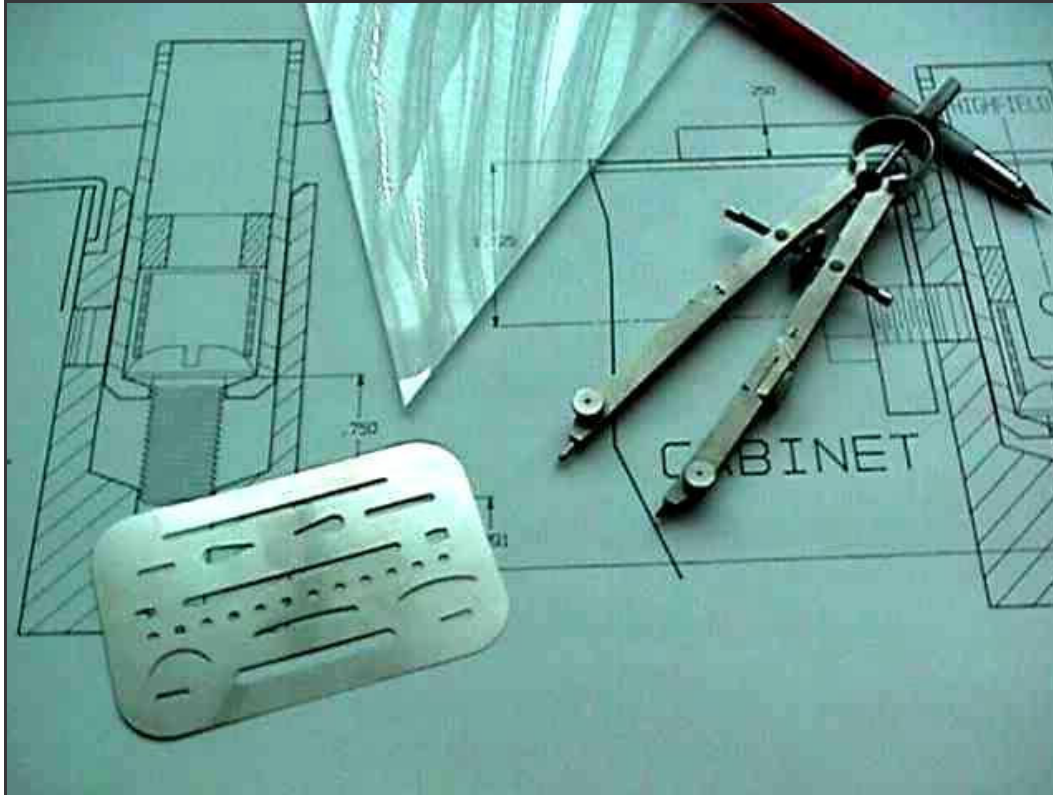

NEED

- Question 1

– I am a \_\_\_\_\_ Engineering student.  
Do I really need to learn drawing?

- Answer

– If you want to be an Engineer,  
and not just an engineering degree holder,  
you need to learn drawing.

- Question 2

– I am a 5-year MSc (Integrated) \_\_\_\_\_ student.  
Do I really need to learn drawing?

- Answer

– Engineering involves application of science.

### Who knows?

Some of you may fall in love with Engineering; like many other scientists who were originally science graduates, you may also pursue engineering careers in future.

- Why Engineering Drawing is necessary ?

- First skill of an engineer

- Plan the work

- Second skill of an engineer

- To work the plan

- Both require maps/drawings/sketches



An engineer ...



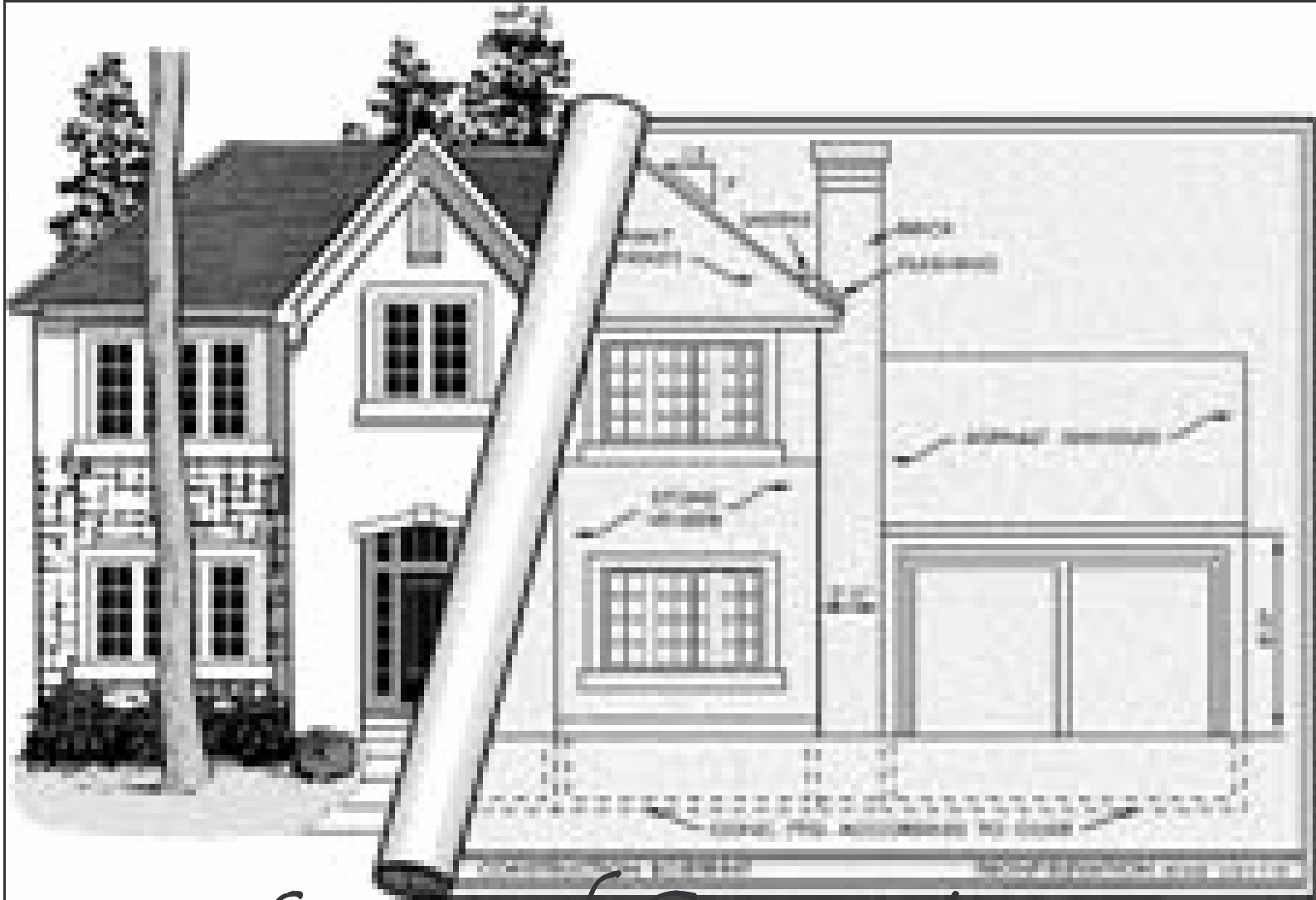

# Sense of Geometry

9

cvrml@iitk.ac.in :: TA 101 :: 2007-08 II



Big picture...



# Imagination

11

CVLH@HKS.COM || 14101 || 200700 H



Feel both the  
seen & unseen  
surfaces

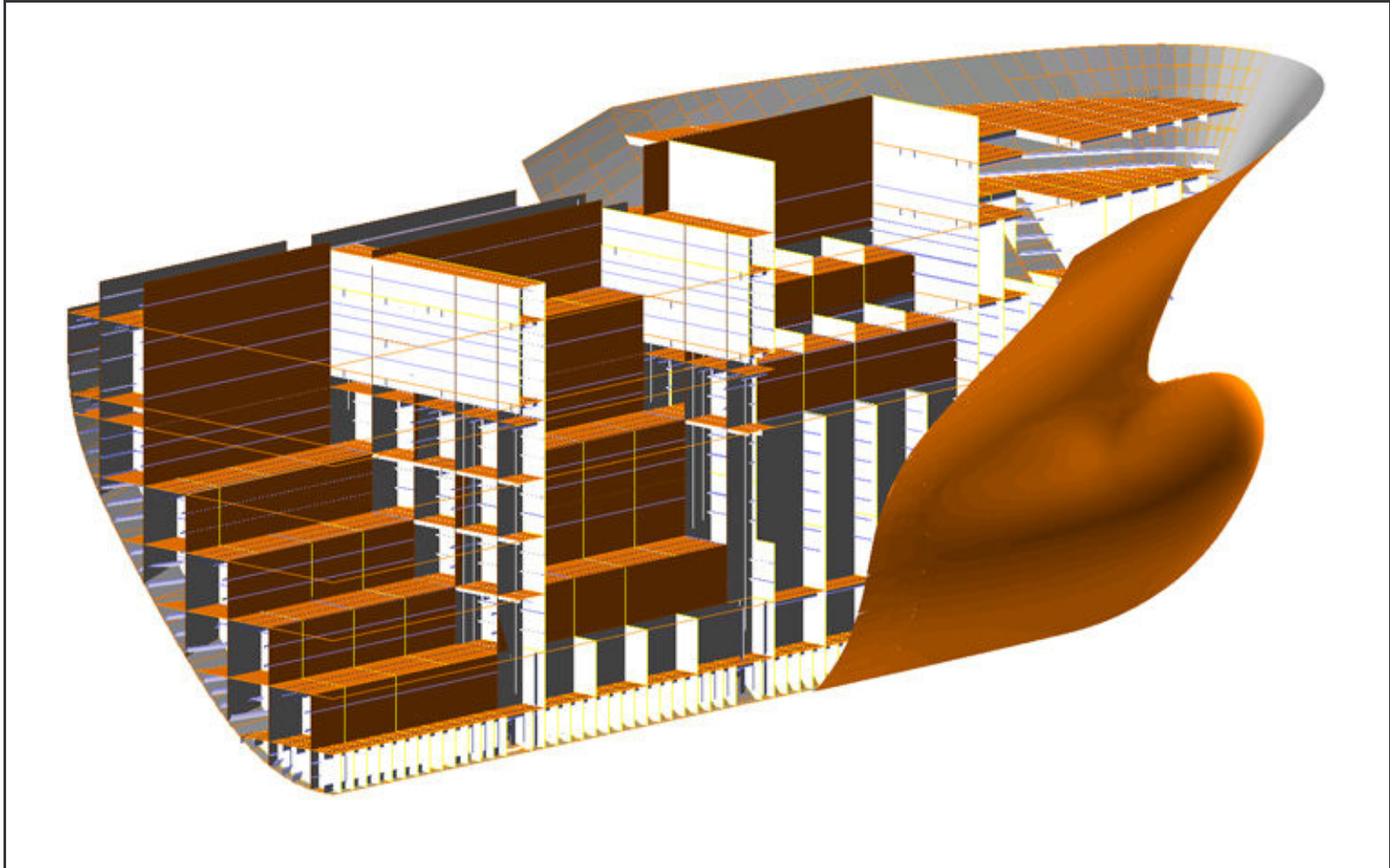

# Design Conception

# Analytical Capability

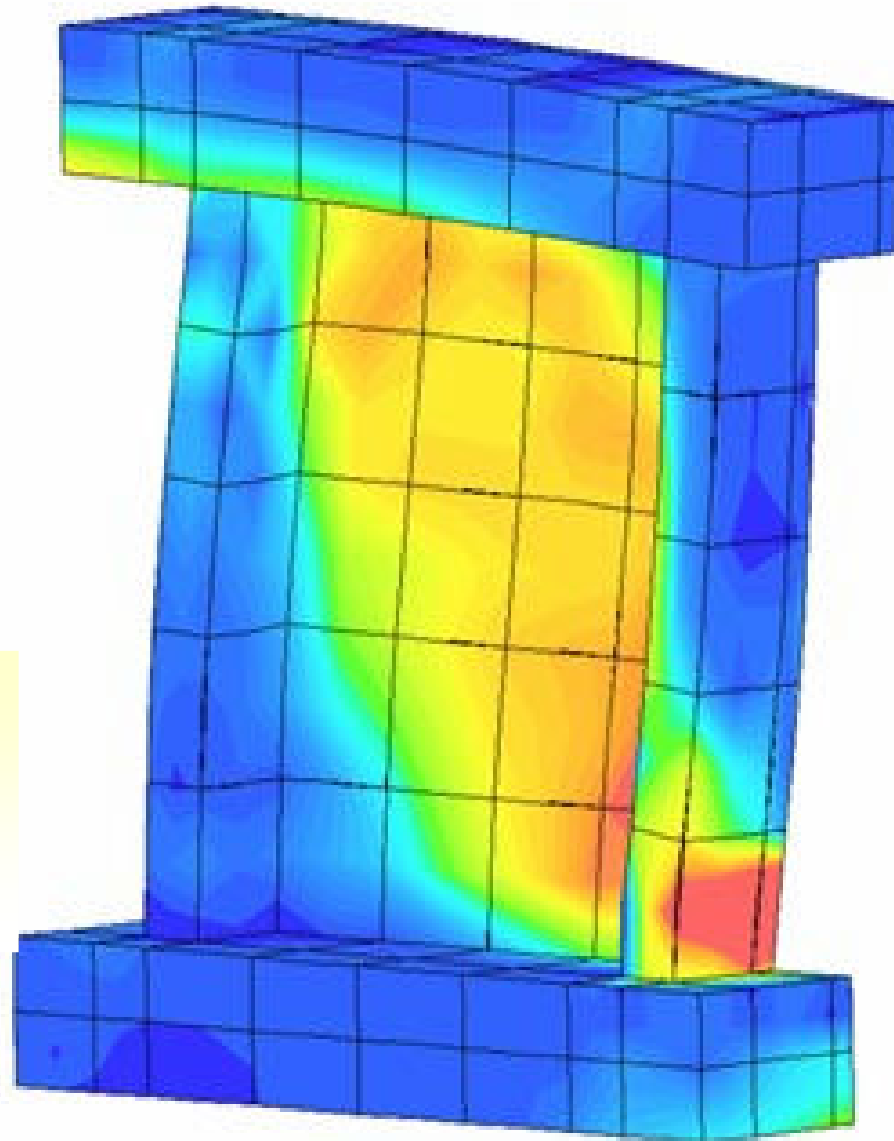



# Nerves for Execution





Respect for Safety...



# Common Sense

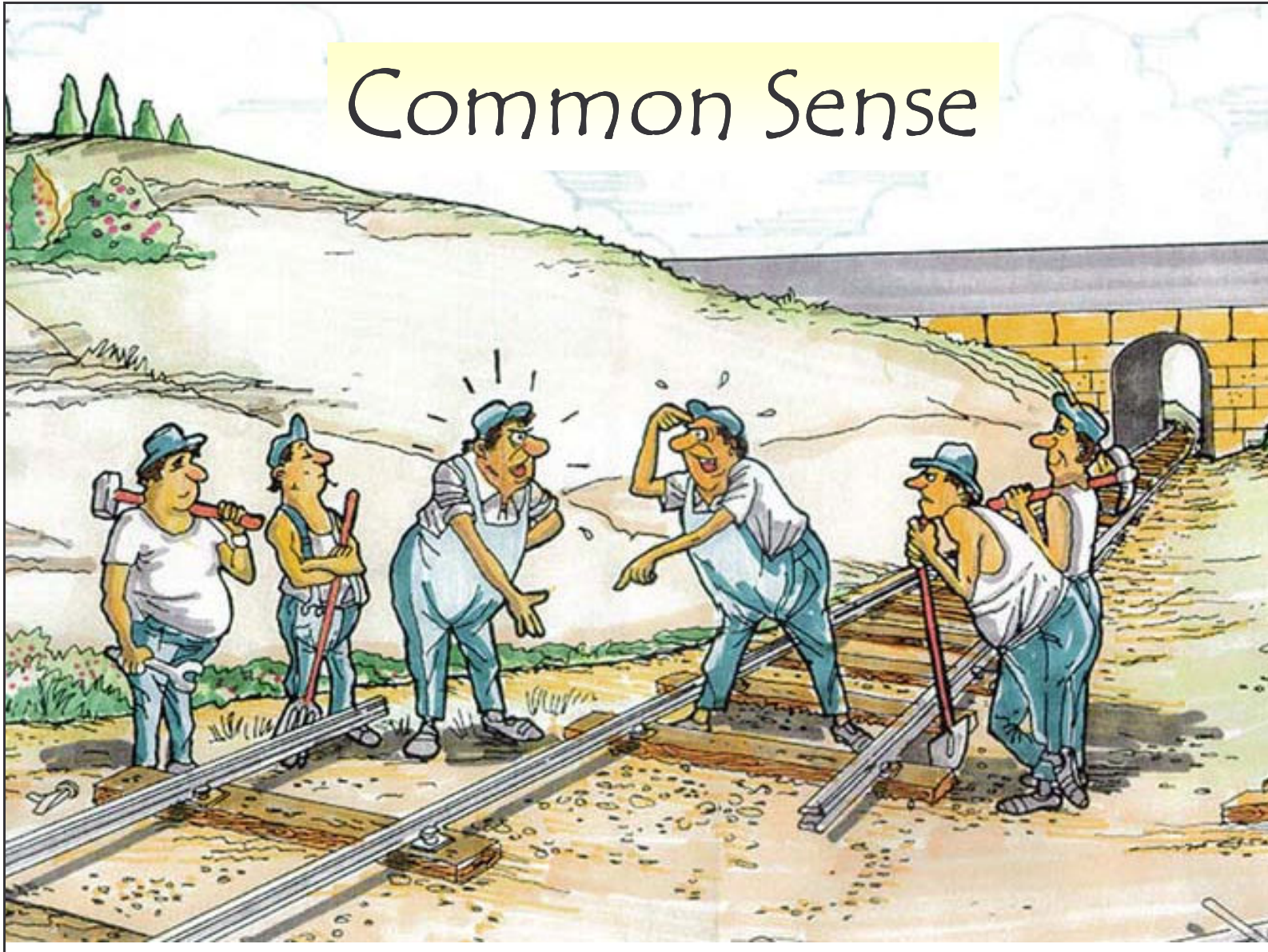





# NEED

---

[cvrn@iitk.ac.in](mailto:cvrn@iitk.ac.in) :: TA101 :: 2007-08 II

# NEED

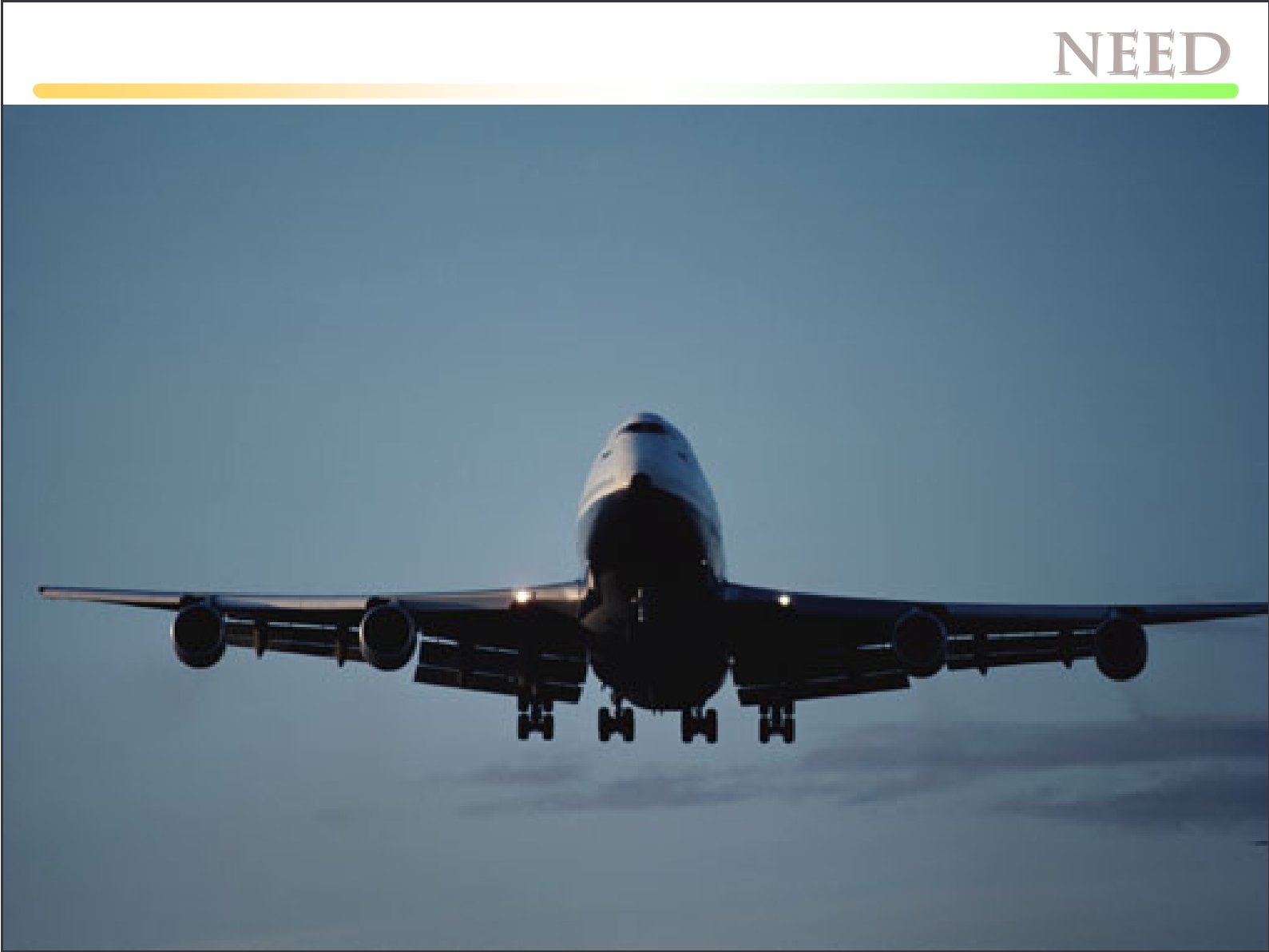

# NEED





# NEED



# NEED





# NEED

---

[cvrn@iitk.ac.in](mailto:cvrn@iitk.ac.in) :: TA101 :: 2007-08 II



# NEED



# NEED



# NEED



# NEED



NEED



NEED

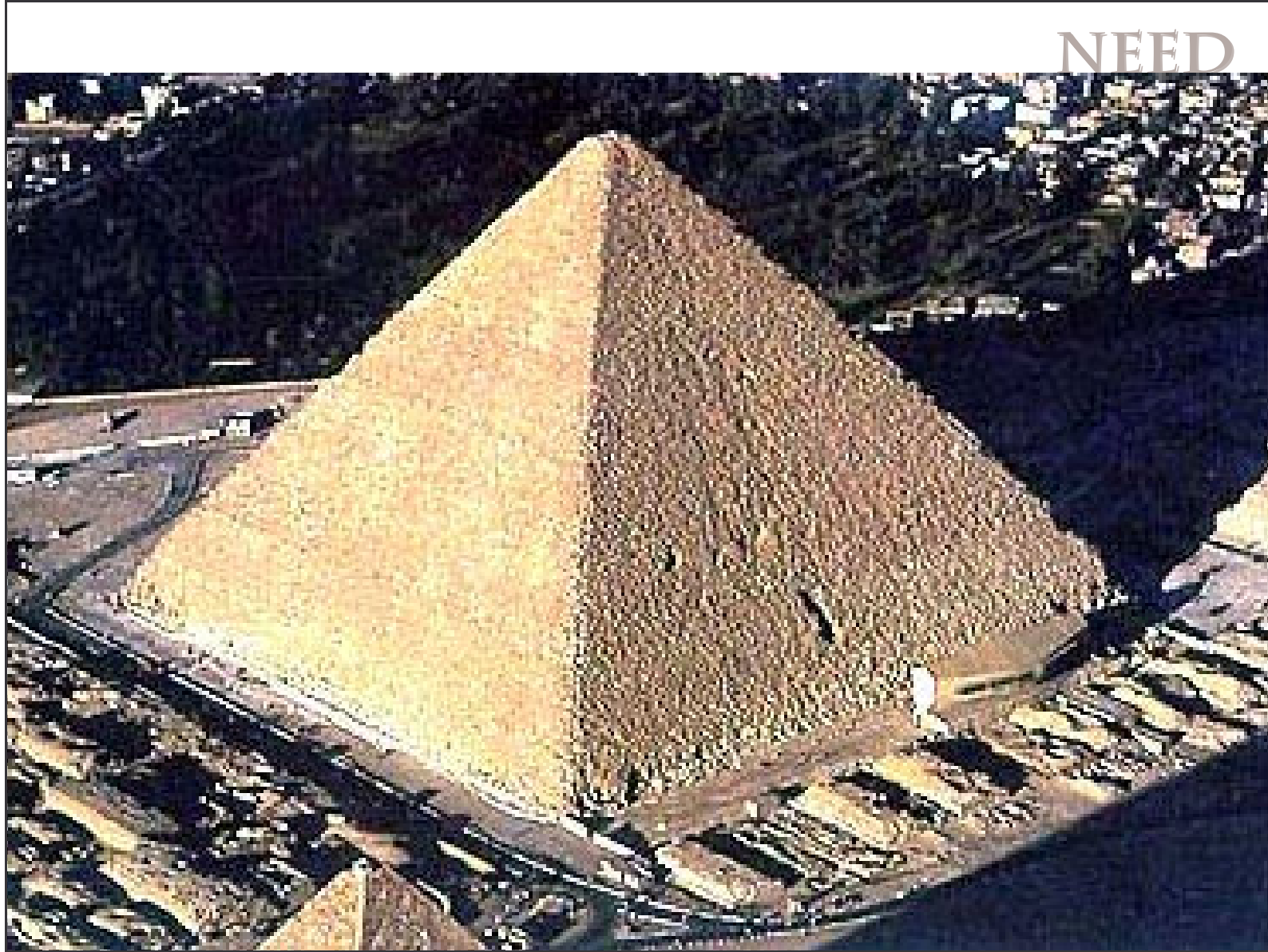

# NEED



# NEED





# NEED



# NEED



# NEED



# NEED



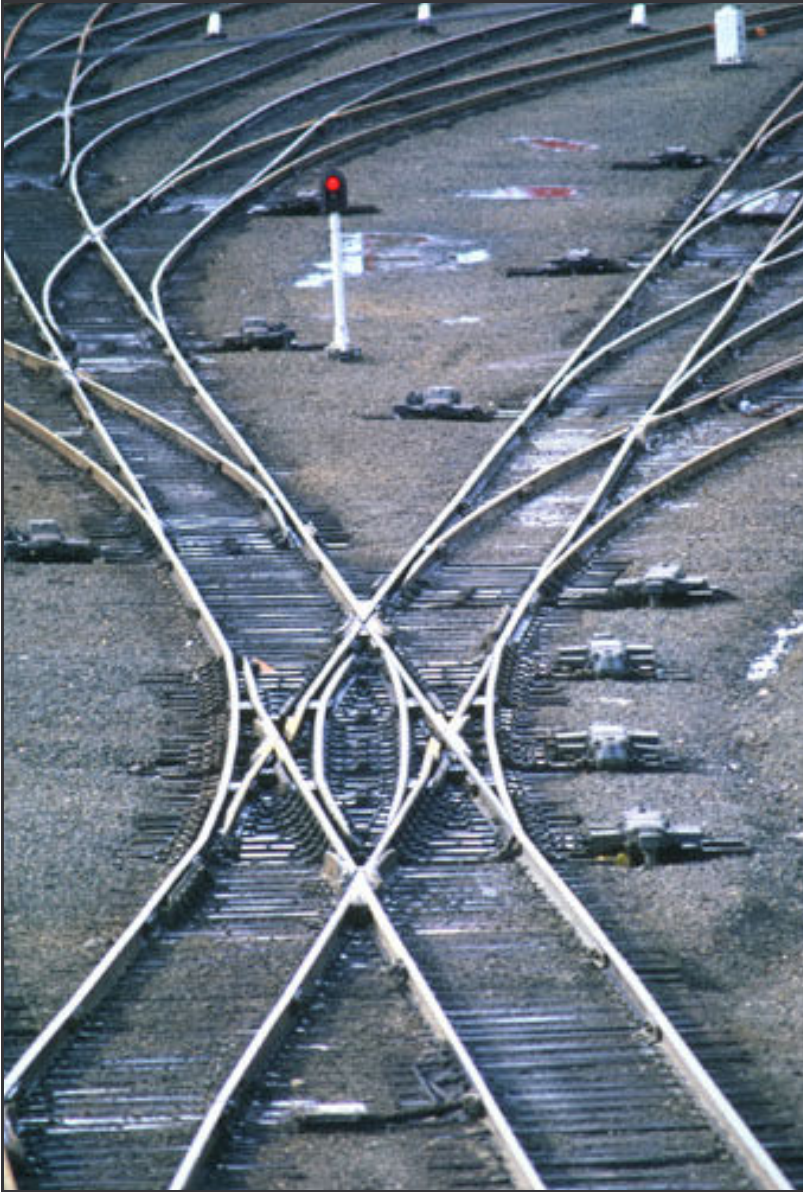

# NEED

---

[cvrn@iitk.ac.in](mailto:cvrn@iitk.ac.in) :: TA101 :: 2007-08 II

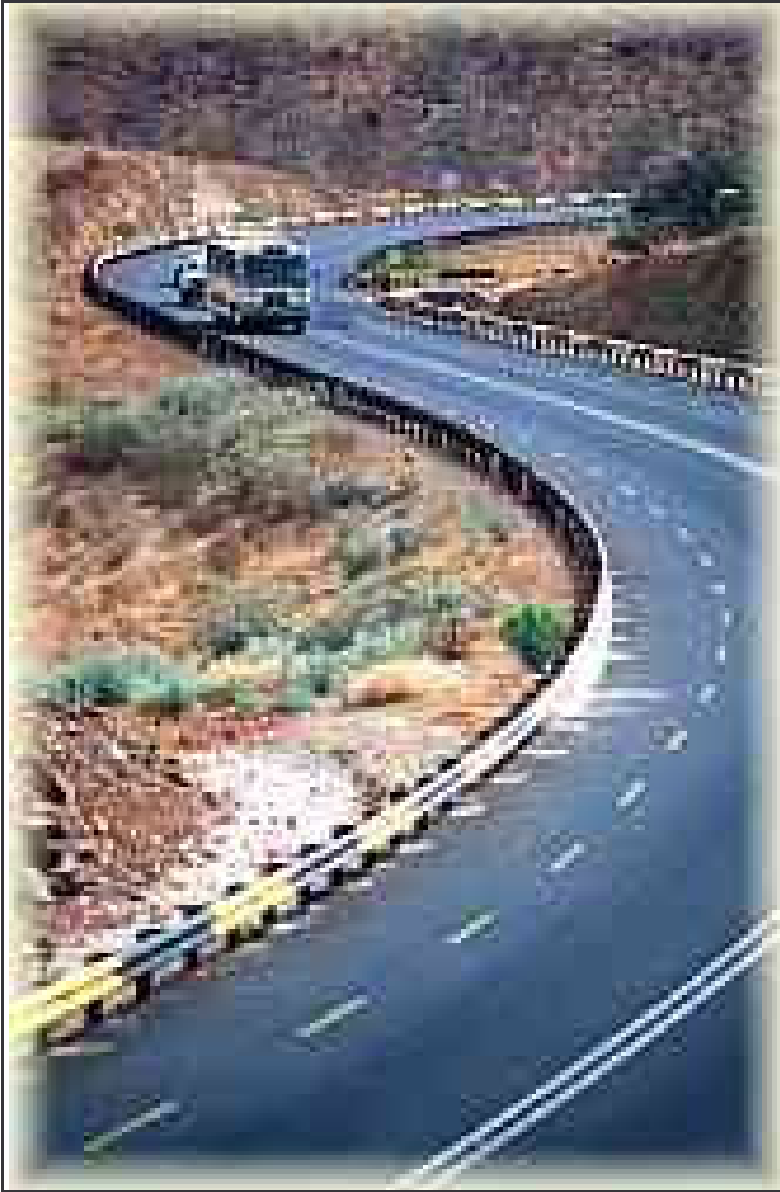

# NEED

---

[cvrn@iitk.ac.in](mailto:cvrn@iitk.ac.in) :: TA101 :: 2007-08 II

# NEED







# NEED

---

[cvrn@iitk.ac.in](mailto:cvrn@iitk.ac.in) :: TA101 :: 2007-08 II



# NEED



# NEED



# NEED







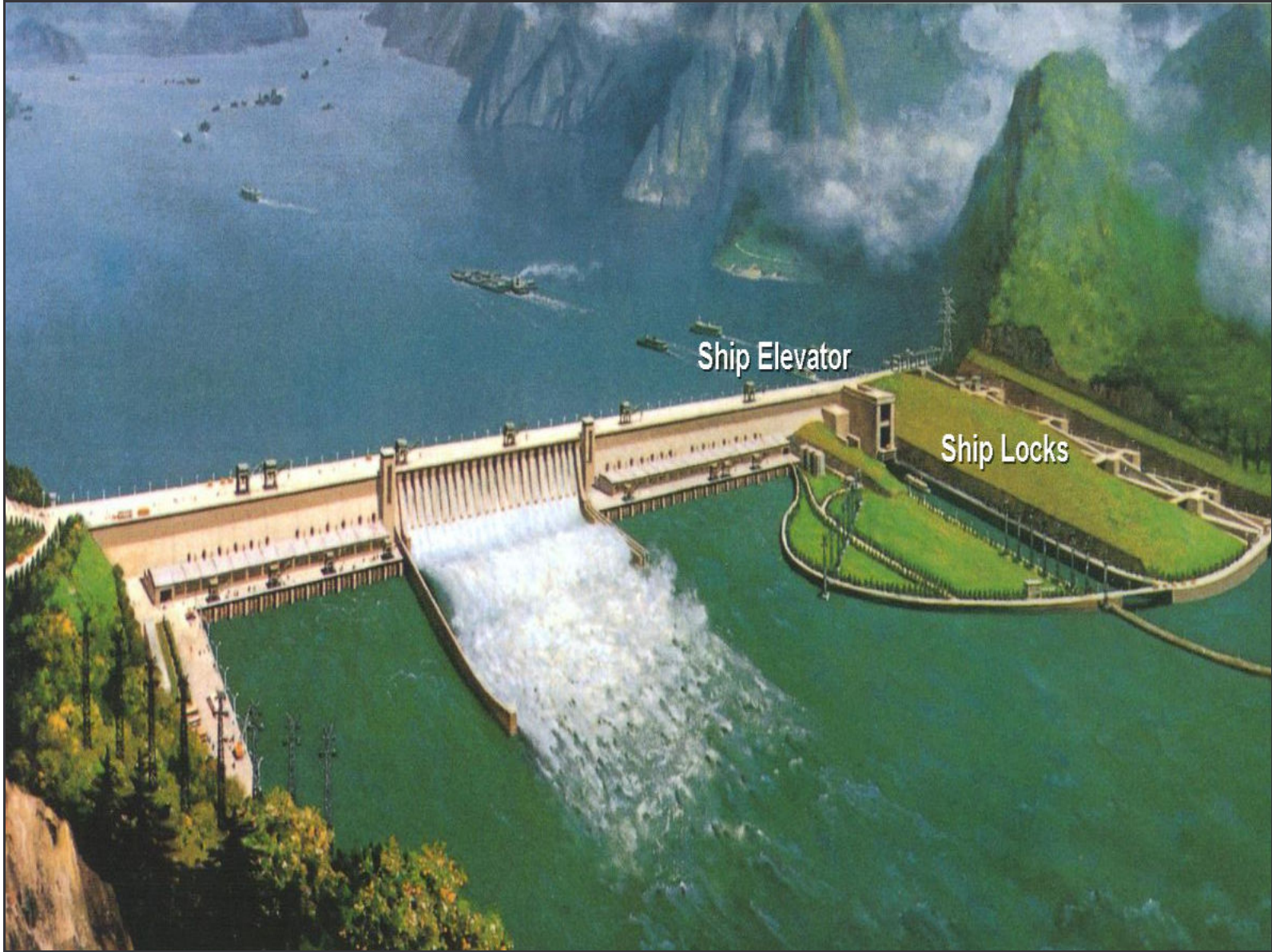

# NEED





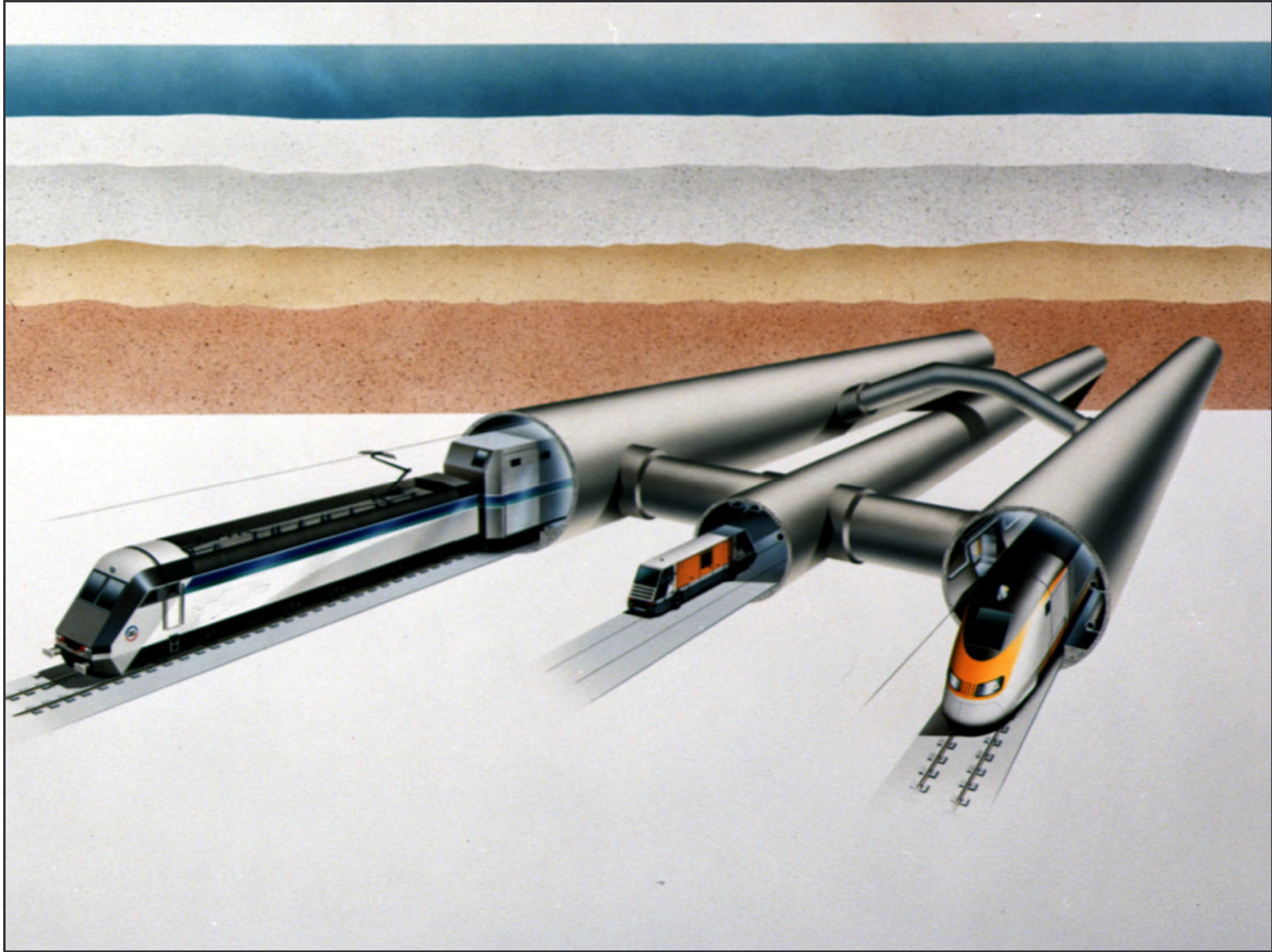

# NEED





# NEED

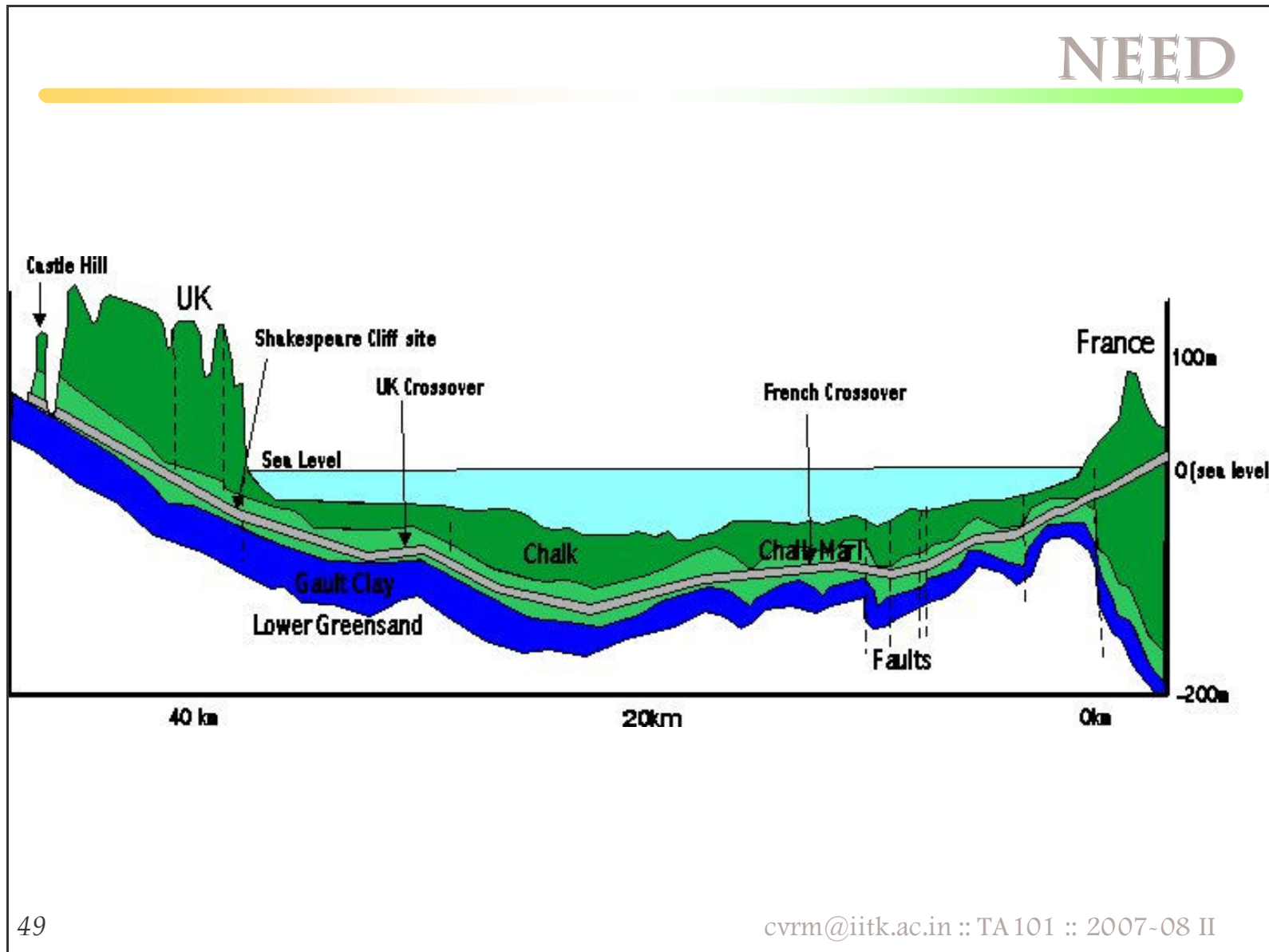

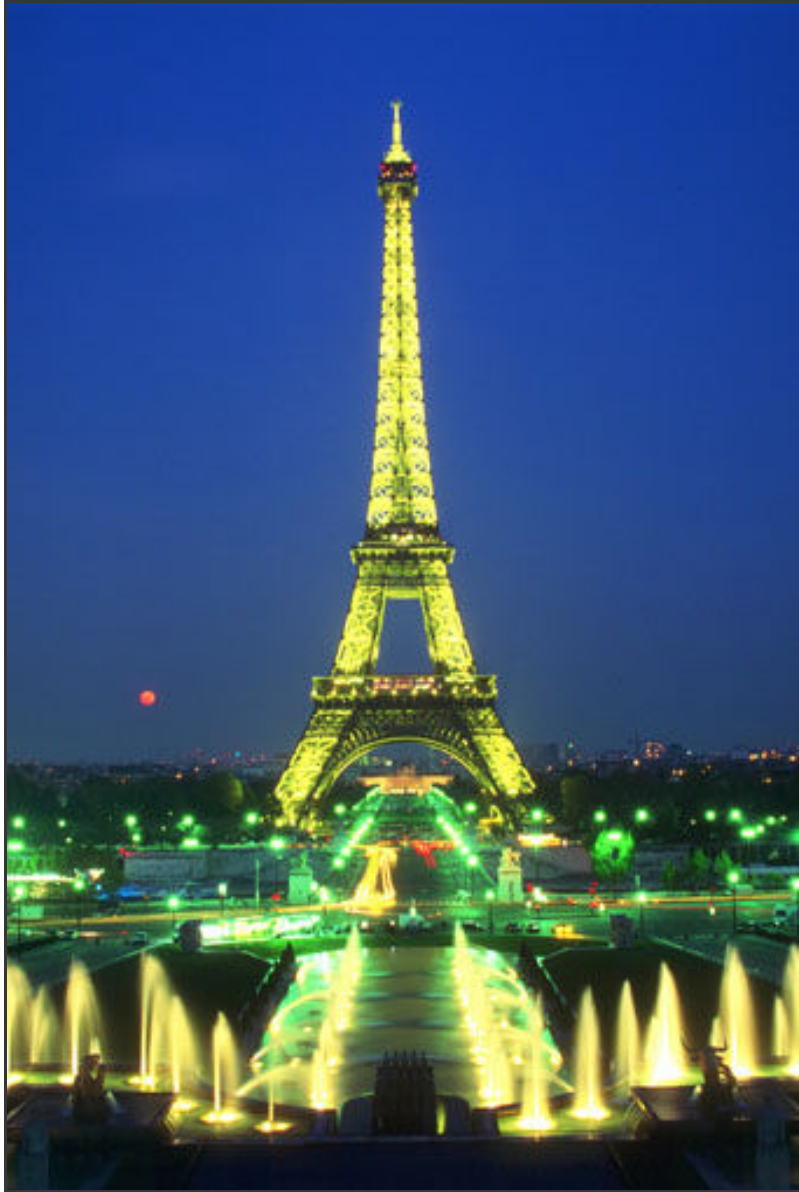

# NEED

---

[cvrn@iitk.ac.in](mailto:cvrn@iitk.ac.in) :: TA101 :: 2007-08 II

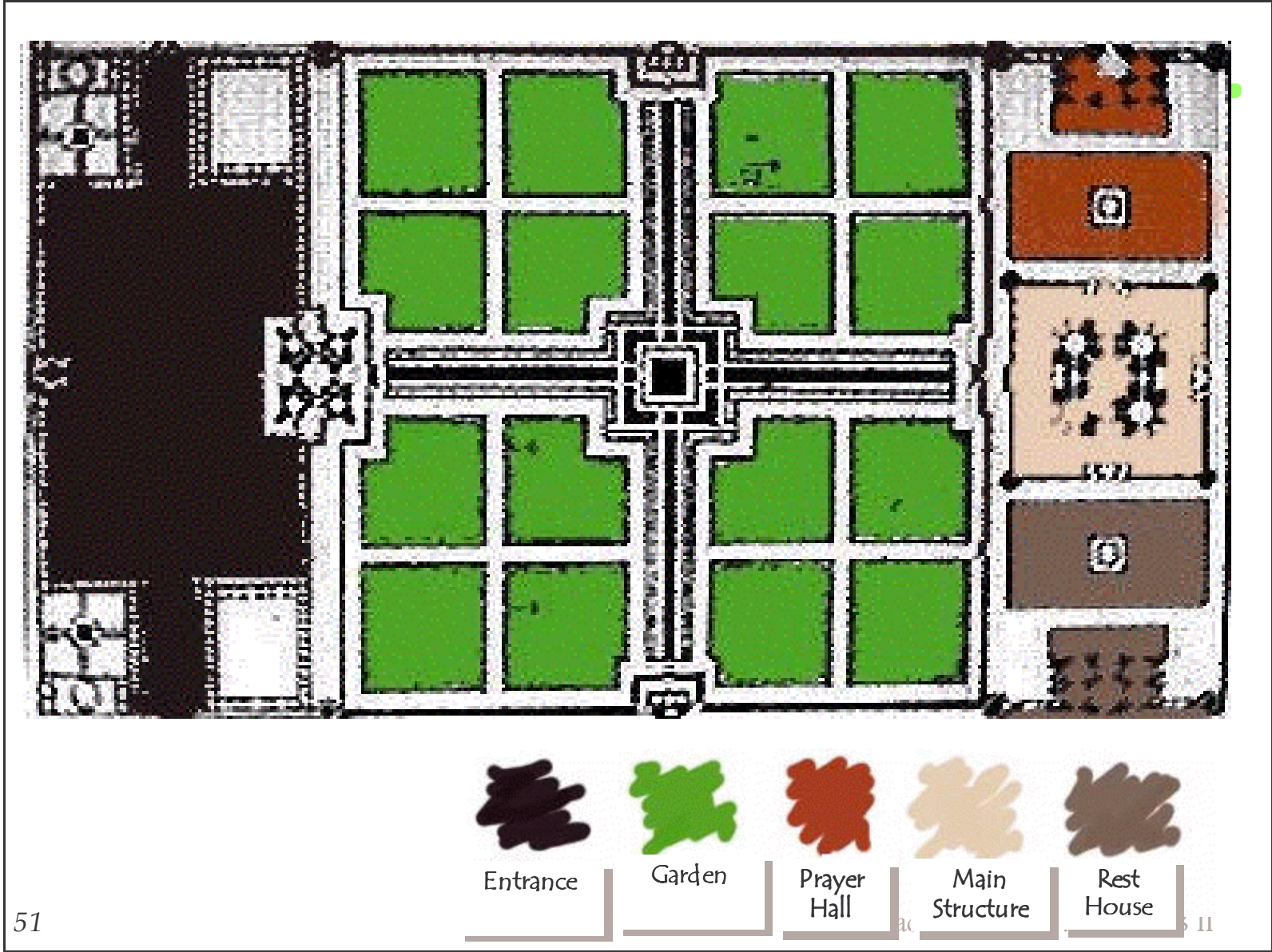

NEED

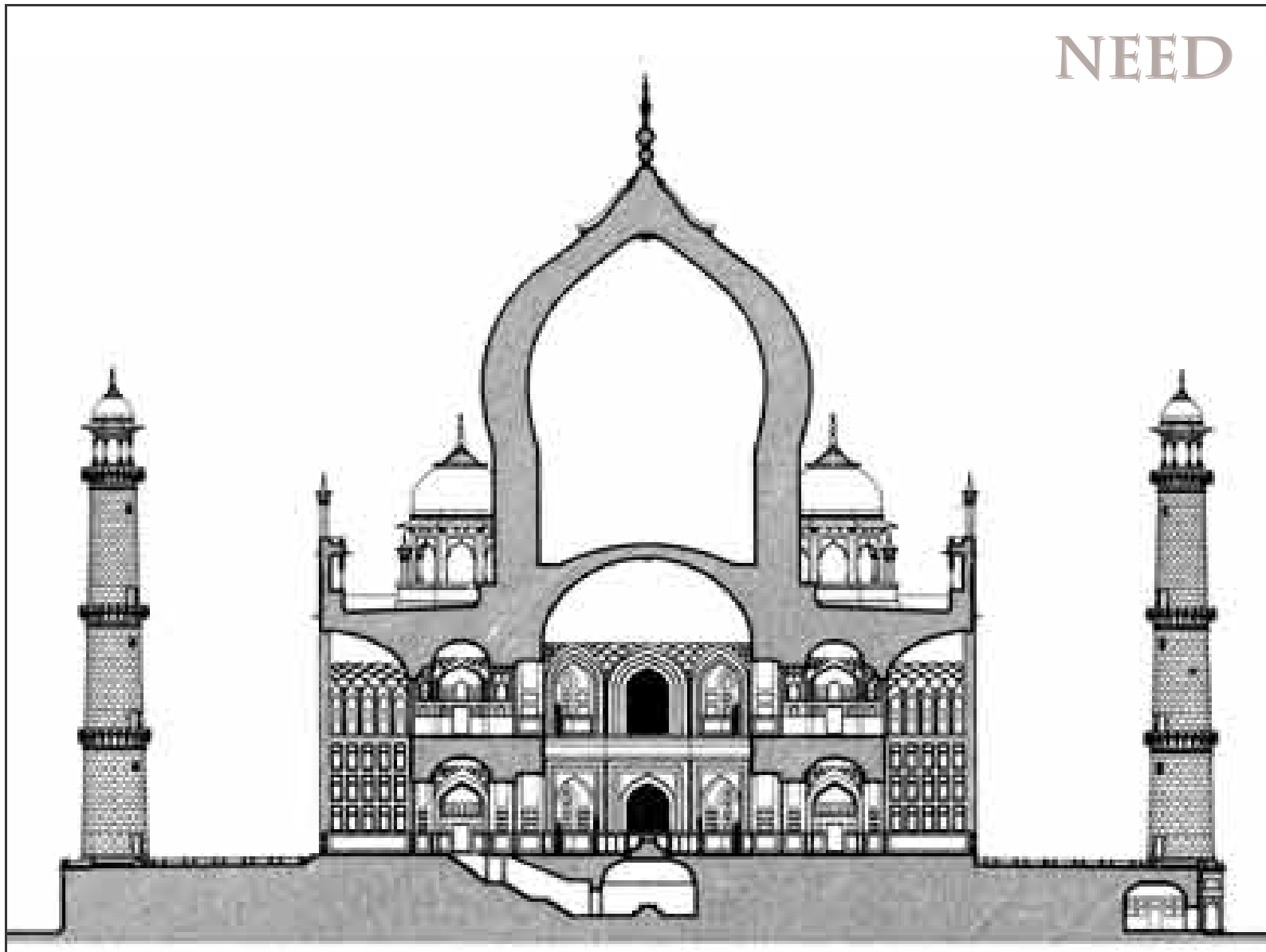

# NEED













# NEED



# NEED











# NEED

---

[cvrn@iitk.ac.in](mailto:cvrn@iitk.ac.in) :: TA101 :: 2007-08 II

# NEED

---



[cvrn@iitk.ac.in](mailto:cvrn@iitk.ac.in) :: TA101 :: 2007-08 II

# NEED





# NEED

---

[cvrn@iitk.ac.in](mailto:cvrn@iitk.ac.in) :: TA101 :: 2007-08 II





# NEED

---

[cvrn@iitk.ac.in](mailto:cvrn@iitk.ac.in) :: TA101 :: 2007-08 II



# NEED



# NEED

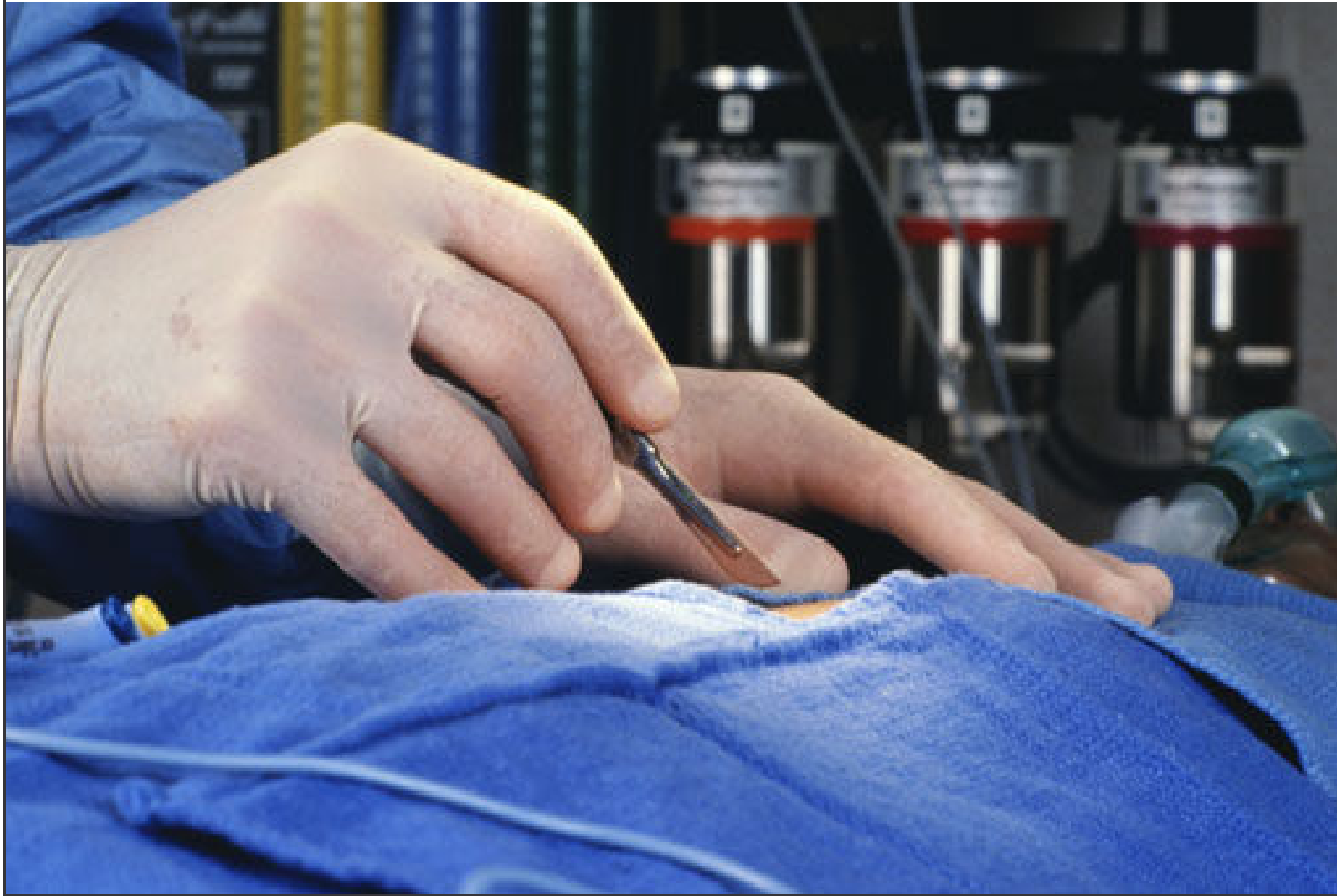

# NEED

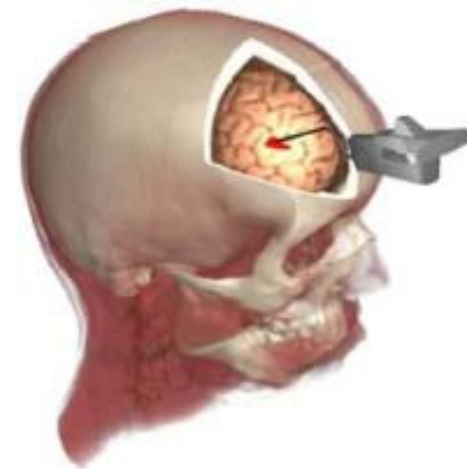

iiitk.ac.in :: TA101 :: 2007-08 II



# NEED

---

[cvrn@iitk.ac.in](mailto:cvrn@iitk.ac.in) :: TA101 :: 2007-08 II



# NEED

---

[cvrn@iitk.ac.in](mailto:cvrn@iitk.ac.in) :: TA101 :: 2007-08 II





# NEED

---

[cvrn@iitk.ac.in](mailto:cvrn@iitk.ac.in) :: TA101 :: 2007-08 II



# NEED



# NEED

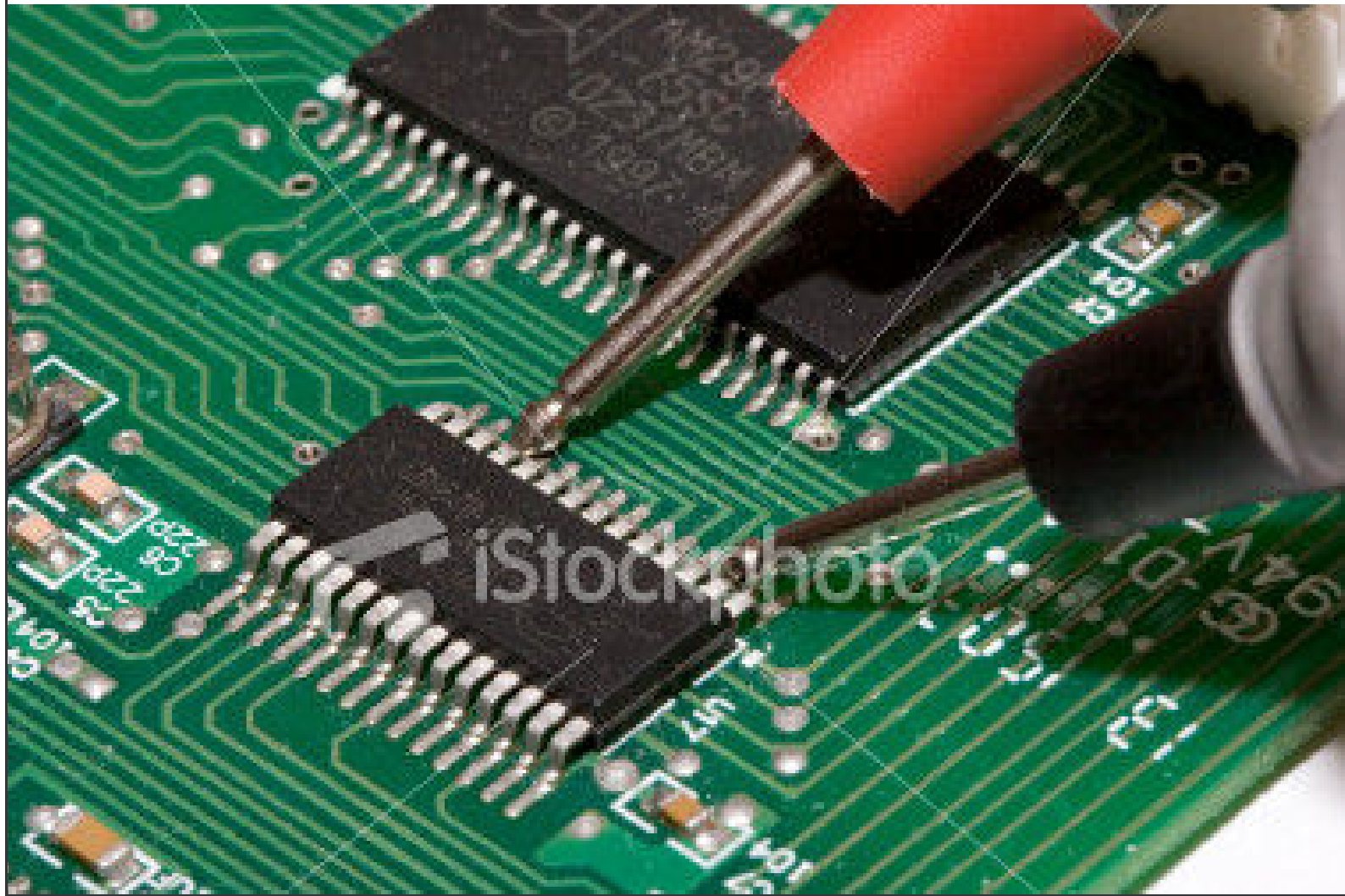

# NEED

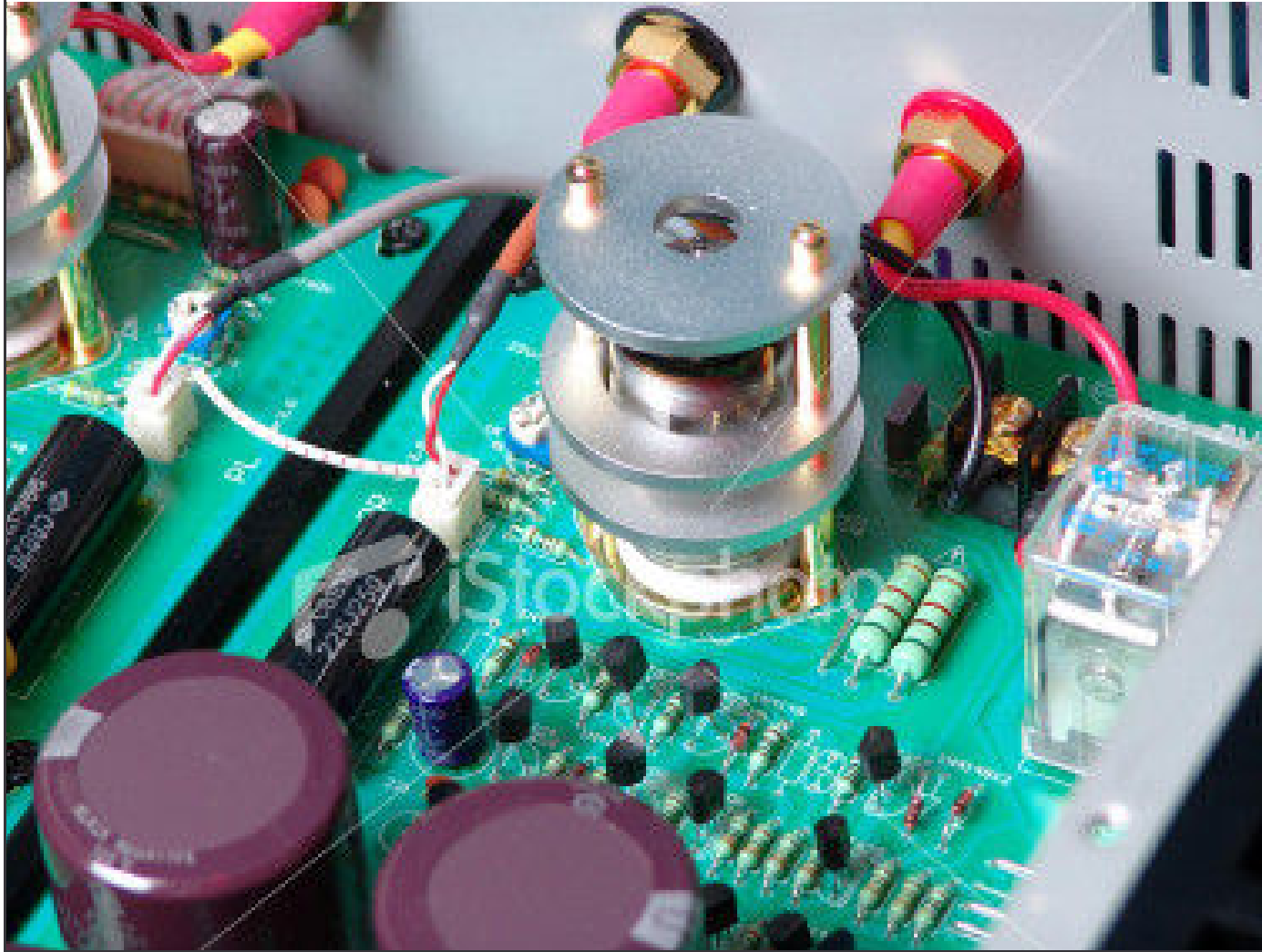

07-08 II

- Virtually nothing gets made without a drawing

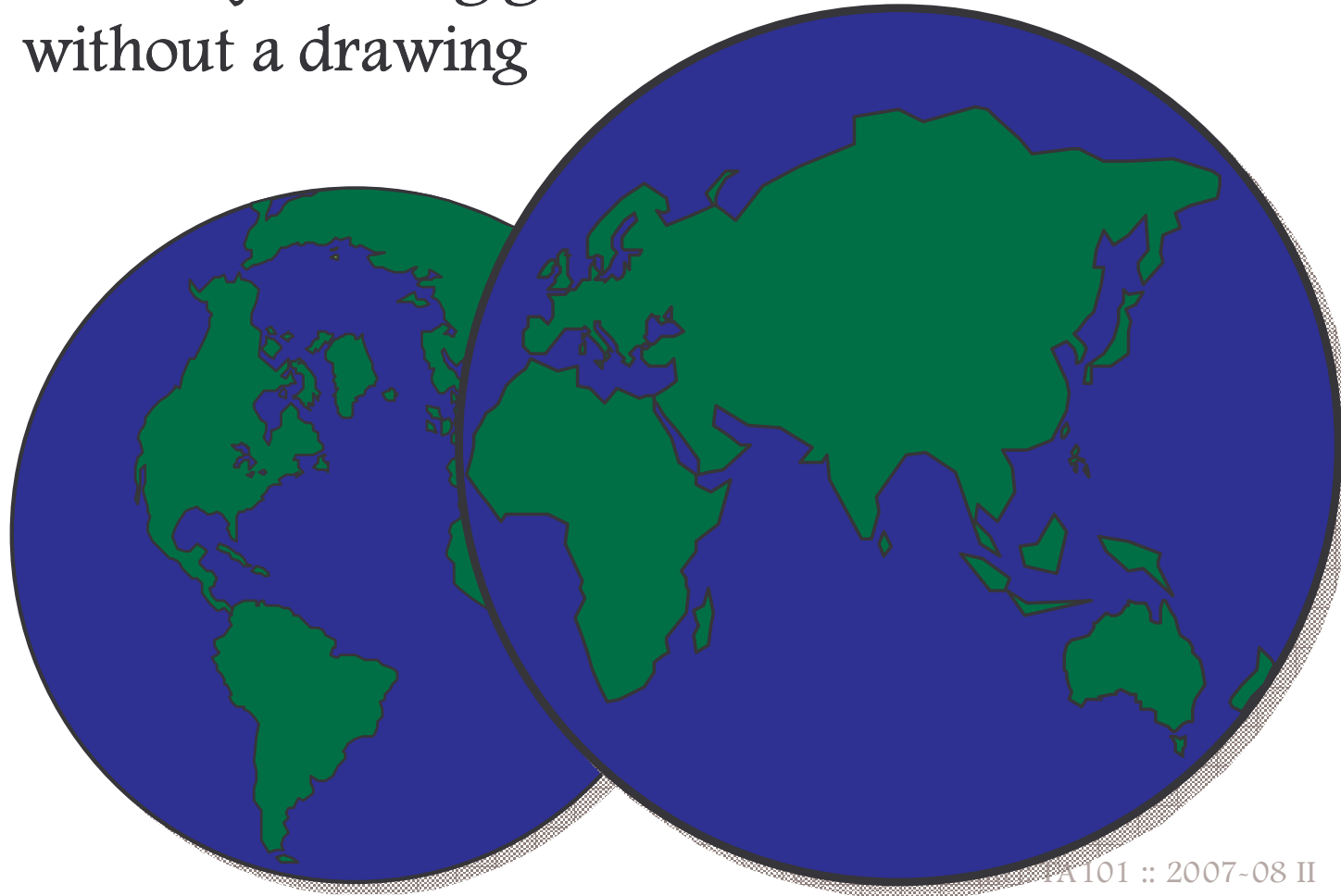

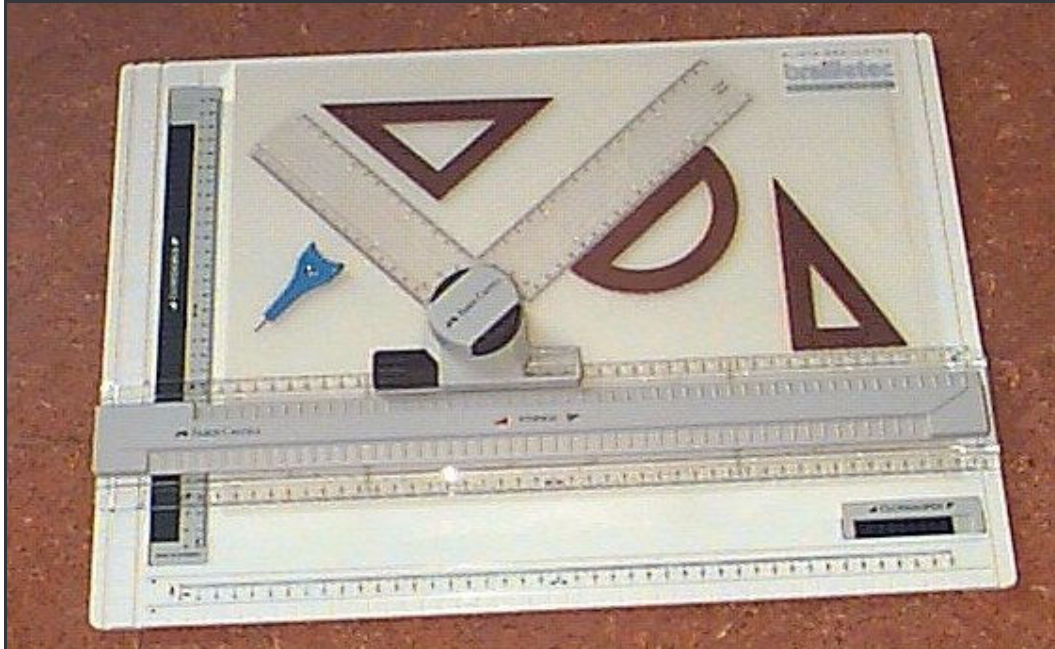

# TOOLS

- Drawing Paper

- Standard paper in India

- A-series

- Constant aspect ratio

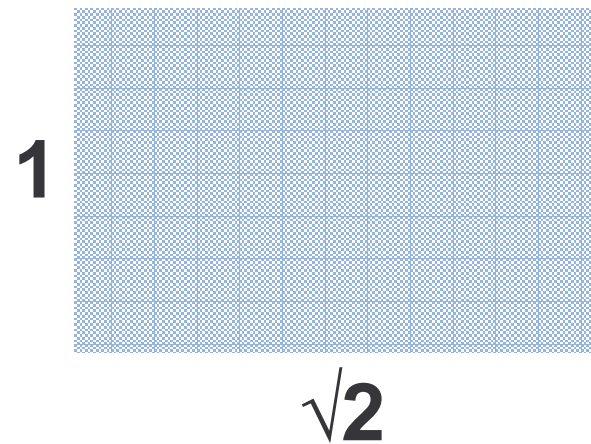

- Drawing Paper...

- Standard paper in India...

- A-series

- A0, A1, A2, A3, A4, ...

- Each size following has half the area of the previous size

- ✓ Area of A0 = 1 m<sup>2</sup>                      841mm × 1189mm

- ✓ Area of A1 = 0.5 m<sup>2</sup>                      594mm × 841mm

- ✓ Area of A2 = 0.25 m<sup>2</sup>                      420mm × 594mm

- ✓ Area of A3 = 0.125 m<sup>2</sup>                      297mm × 420mm

- ✓ Area of A4 = 0.0625 m<sup>2</sup>                      210mm × 297mm

- ✓ ...



- Drawing Paper...

- Standard paper in India...

- A-series

- One dimension common for subsequent sizes

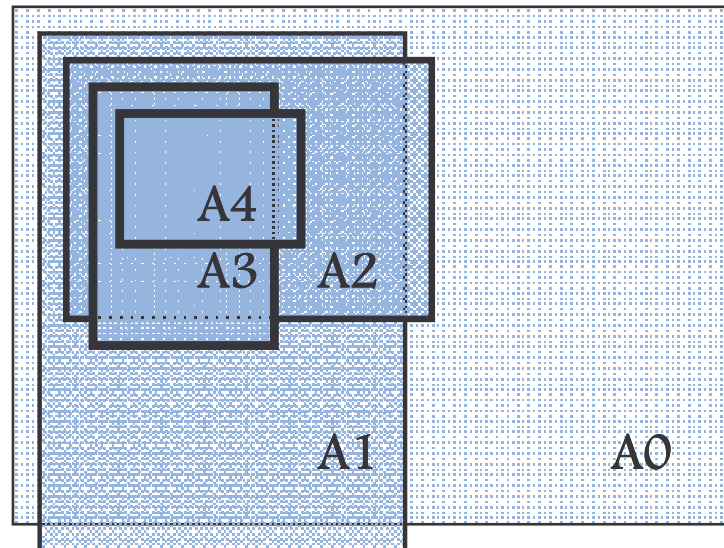

- Question 1

- India uses A-series paper

- What are the other series of papers used elsewhere in the world?

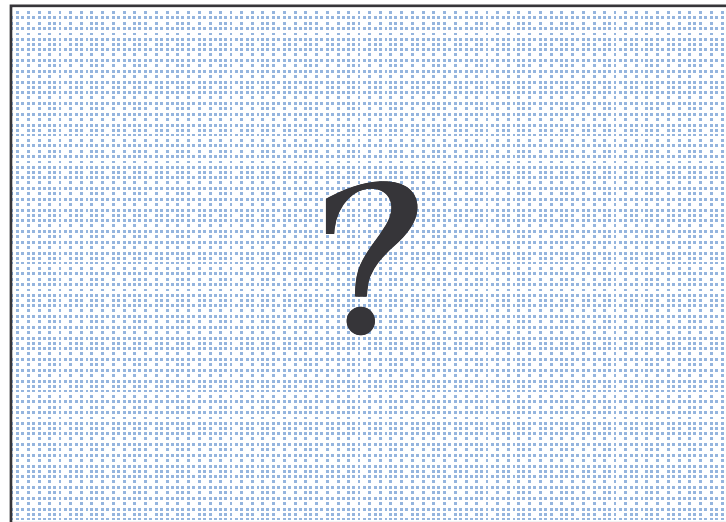

- Question 2

– What is the aspect ratio of the Flags of different countries ?



- Pencil

- Two types

- Wood
- Clutch

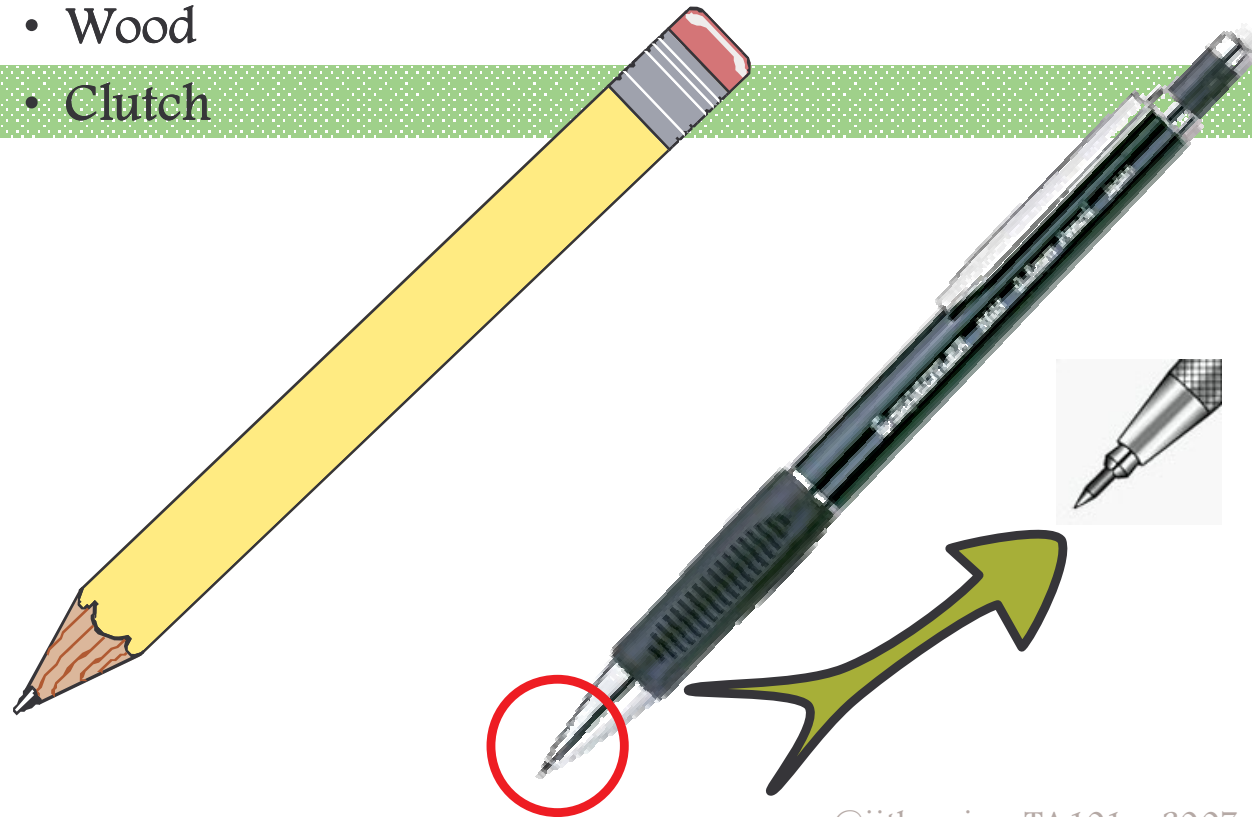

- Pencil Lead

– Standard nomenclature of pencil leads

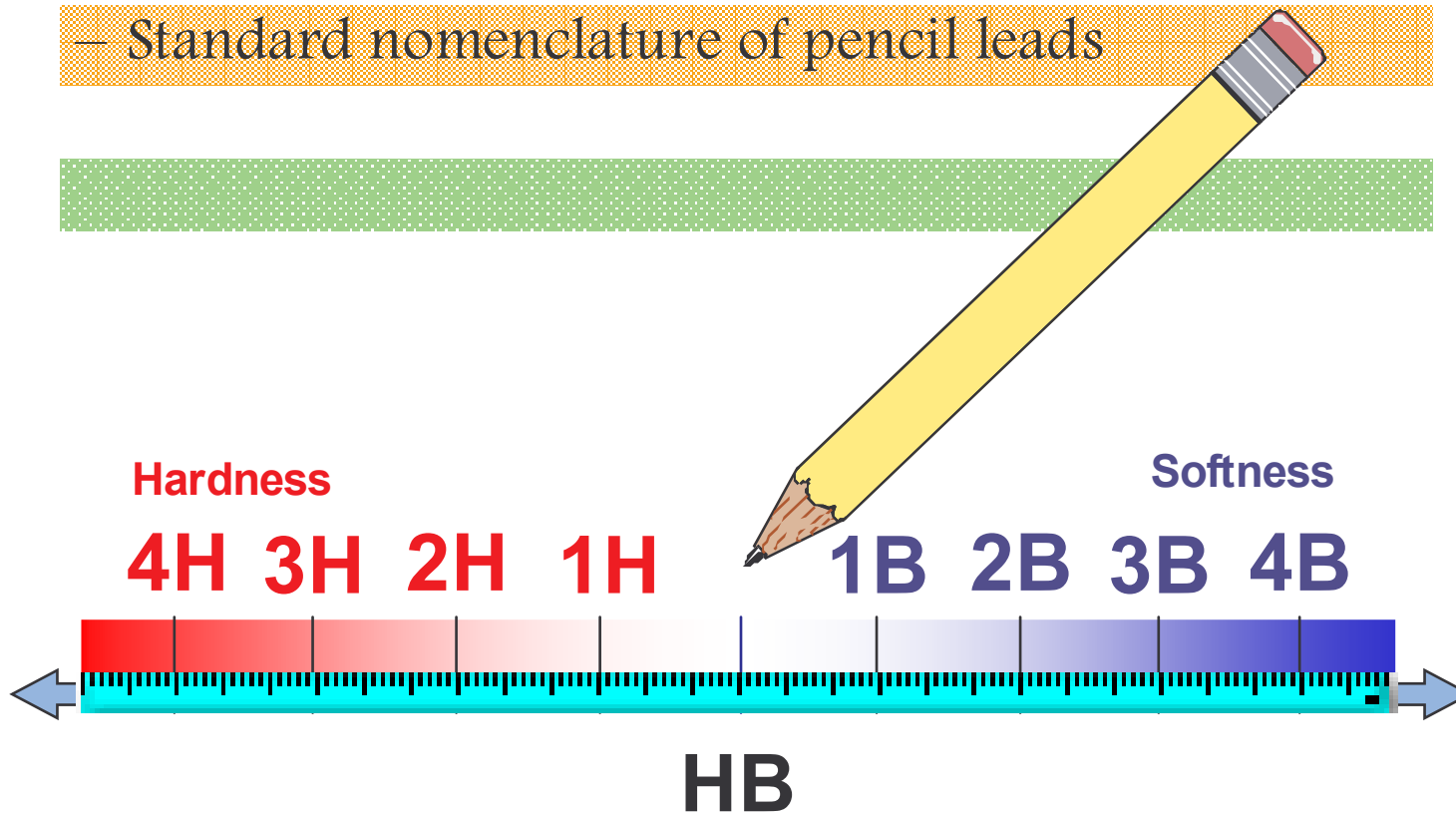

- Pencil...

- Wood Pencil

- Two ways of sharpening the pencil

- Conical tip

- Chisel tip

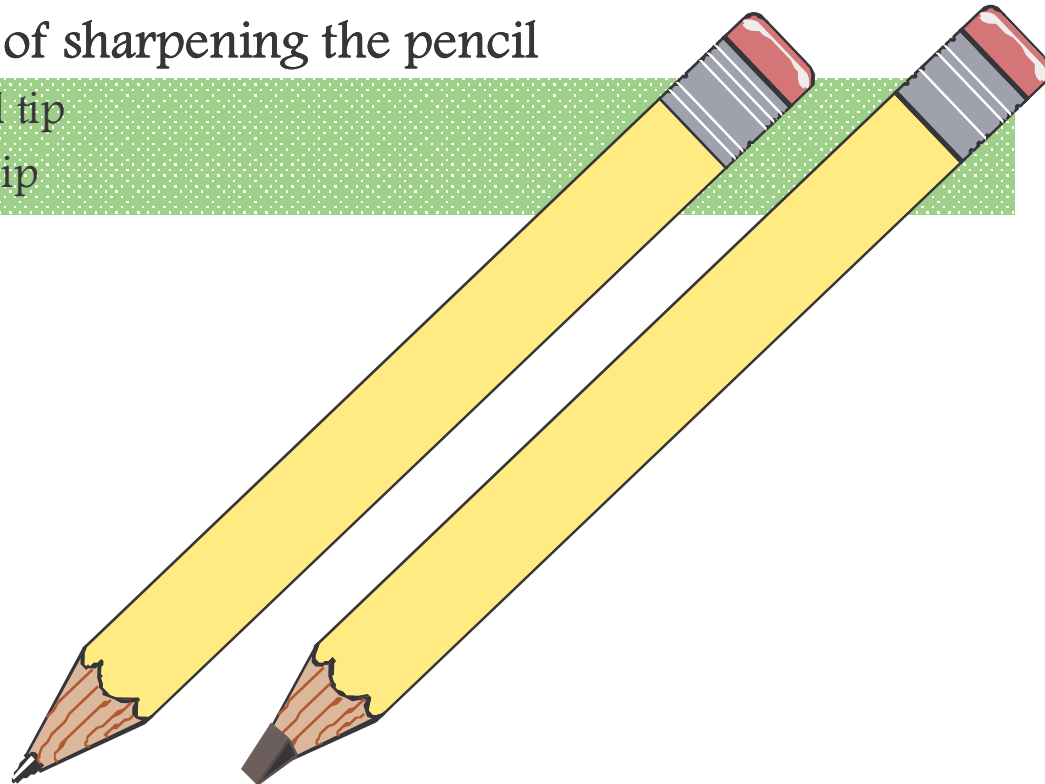



- Pencil...

- Wood Pencil

- Made with quality wood



- **Compass and Divider**

- **Compass**

- Make circles

- **Divider**

- Mark sizes

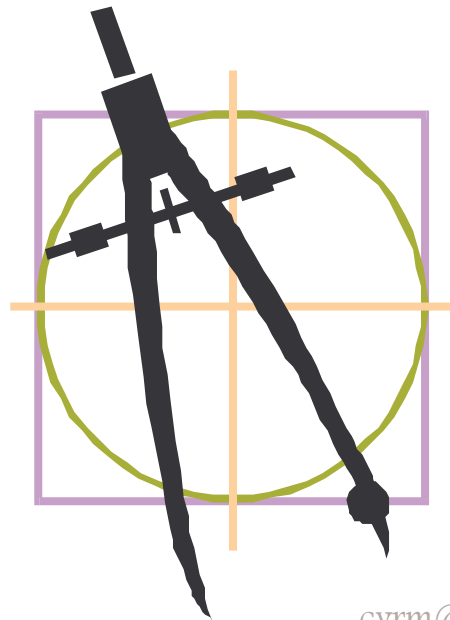

- Compass and Divider...

- Need good quality

- Pointed tips

- Pencil leads



- Set squares

- Two standard ones

- $45^\circ$

- $30^\circ$ - $60^\circ$

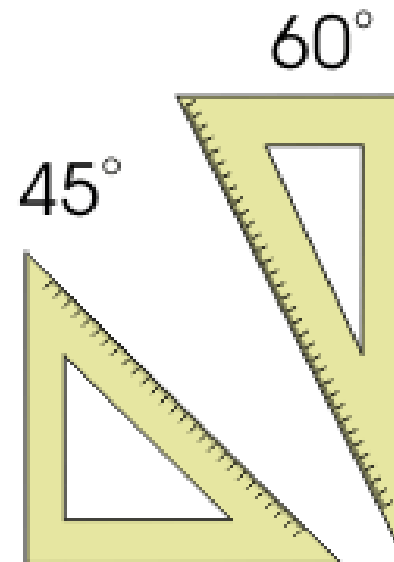

- Scales

- SI Scale

- Millimeters

- Material

- Steel
    - Hard Plastic

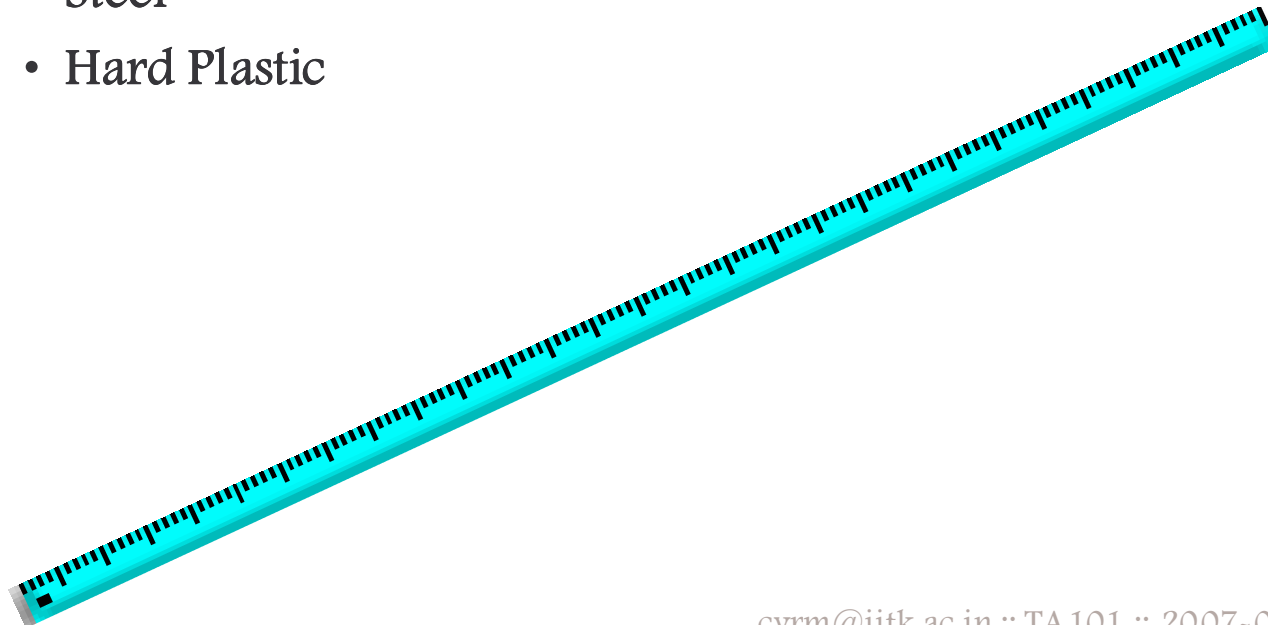

- Drafter
  - Multiple facilities
    - Scales
    - Protractor
    - Parallel lines

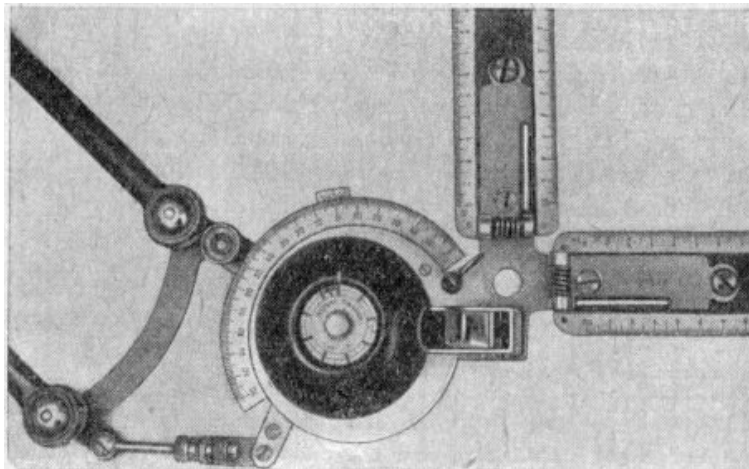

91

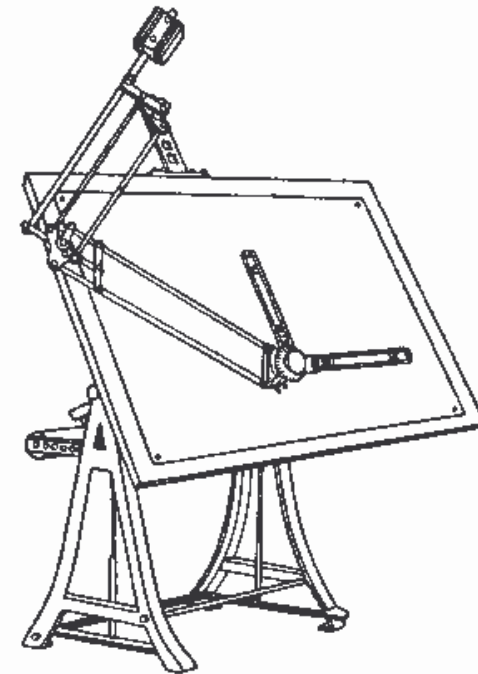

CVIII



- Drafter...
  - Mini-drafter
    - For engineering studies
  - Regular drafter
    - For professional work

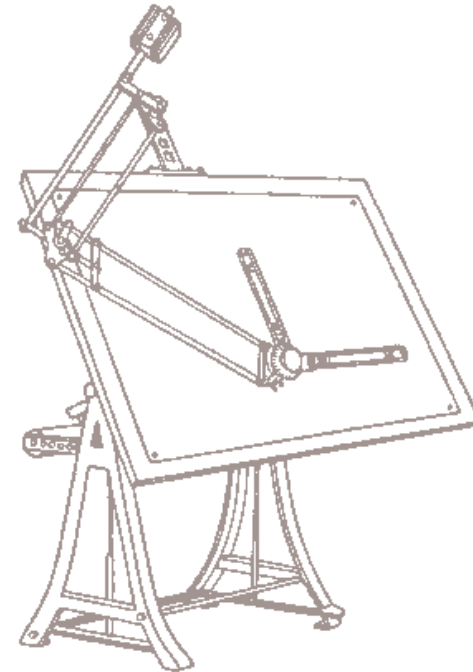

- French curves

- Size

- Order of curves

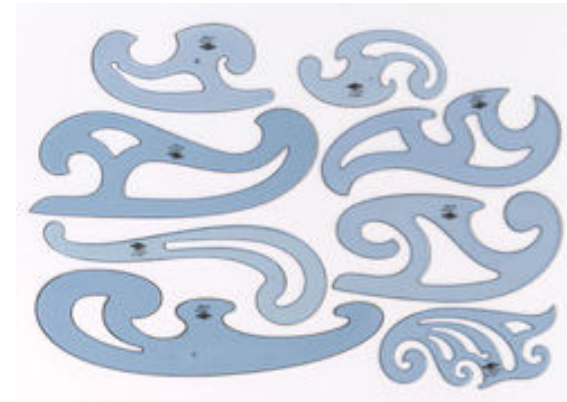
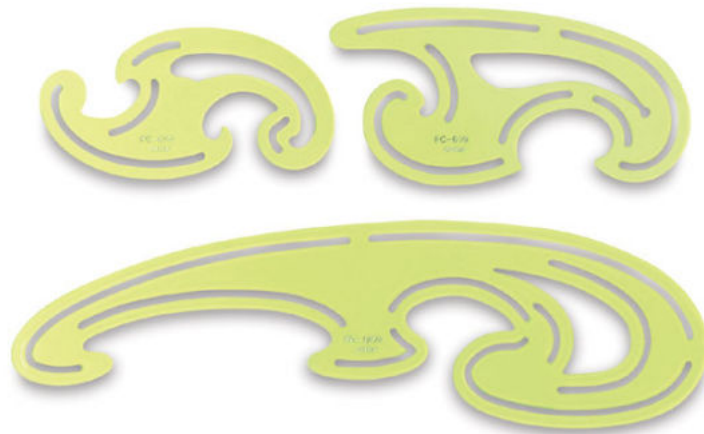

- French curves...

- Use

- At least three points to be connected need to touch any section of the French Curve

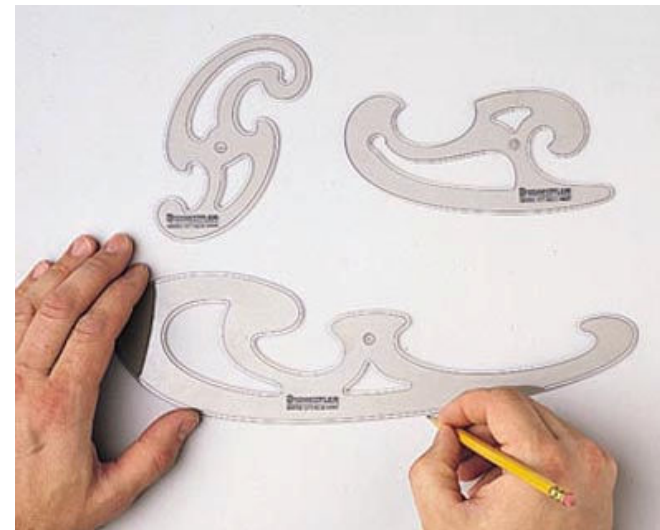
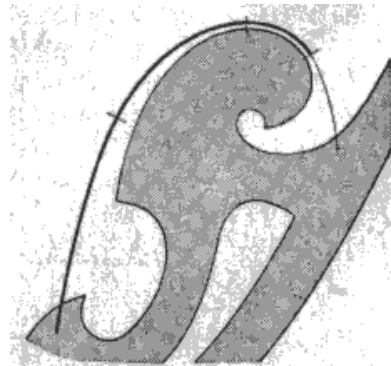
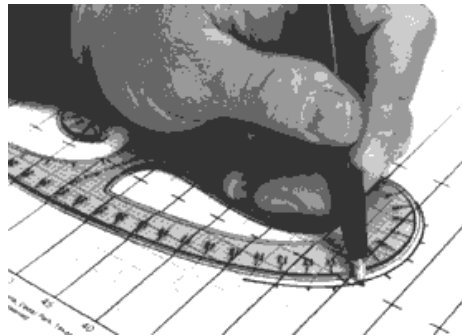

- Drawing Clip

- Clamp the sheet on to the board

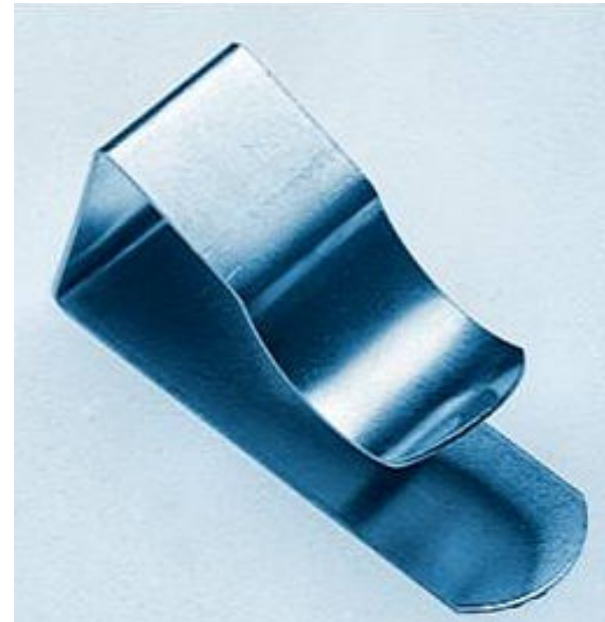

- Drawing Board Table

- Height and Tilt

- To be adjusted by the person using

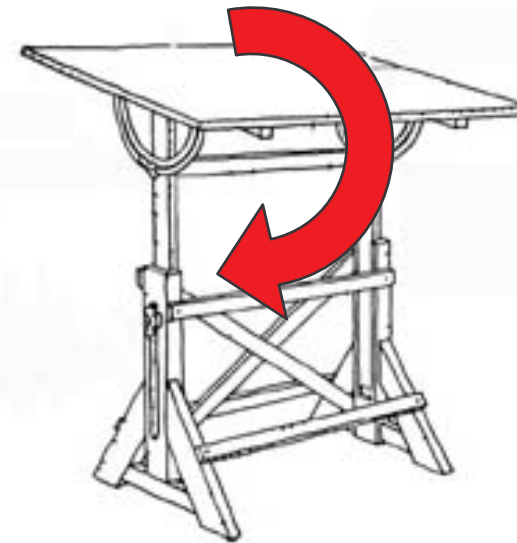
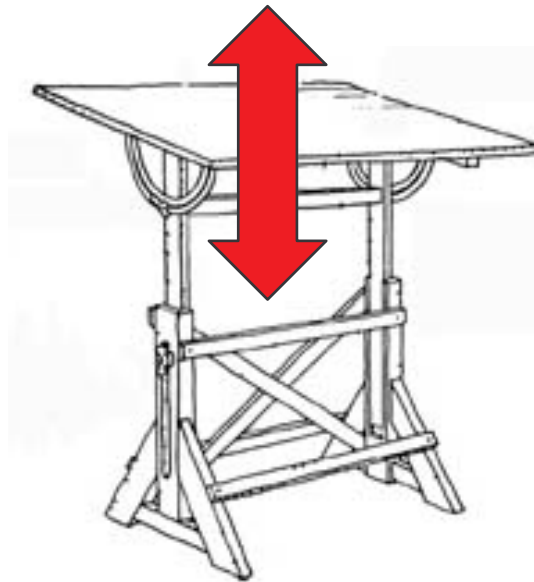

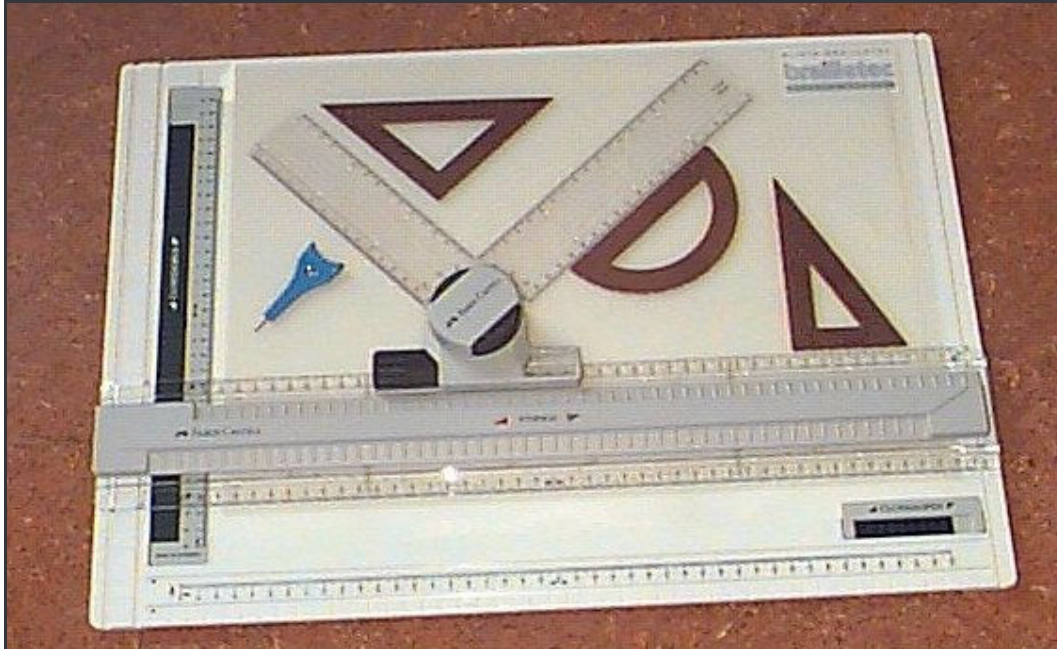

TIPS



## TIPS

- Ensure correct posture of person while drawing
  - Erect back
  - Eyes at least  $\sim 450\text{mm}$  ( $\sim 18$  inches) from sheet
    - Either standing or sitting



- Use good quality instruments
  - This helps enhance accuracy of drawing

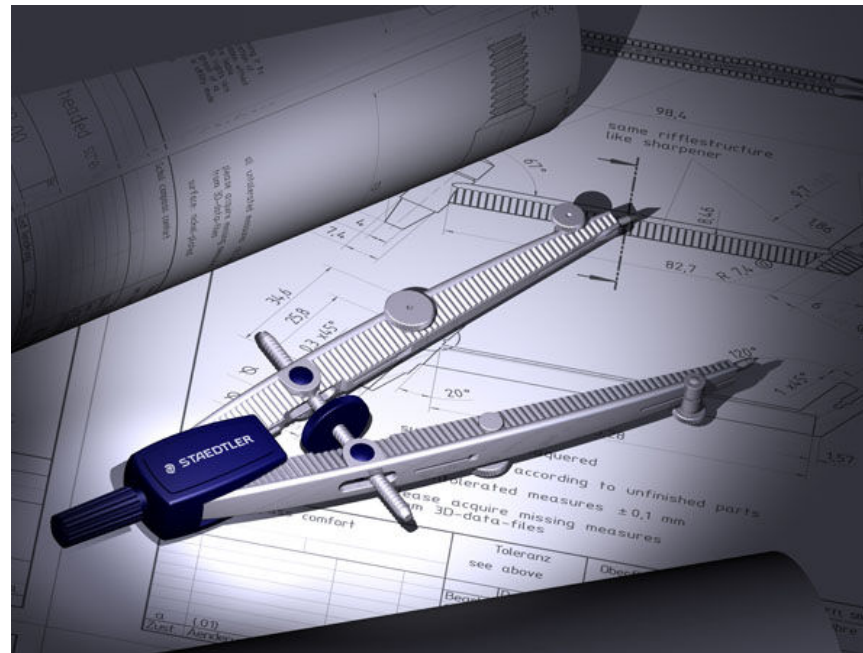

- Do not use both the drafter protractor & the separate protractor for seeking angles
  - Use EITHER the protractor on the drafter OR a separate protractor
    - Not BOTH
    - This will maintain consistency in measurement of angles
    - Separate protractor is more accurate

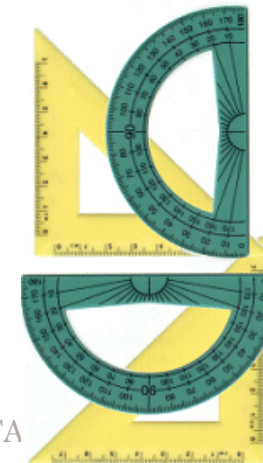
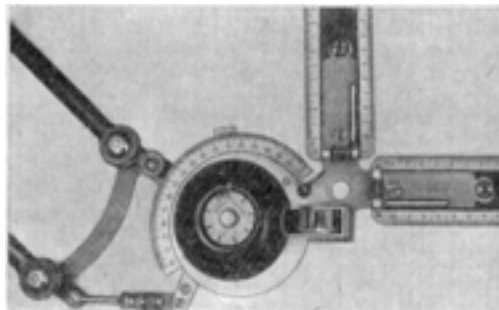

# TIPS

- Butt the pencil vertically against the straight edge

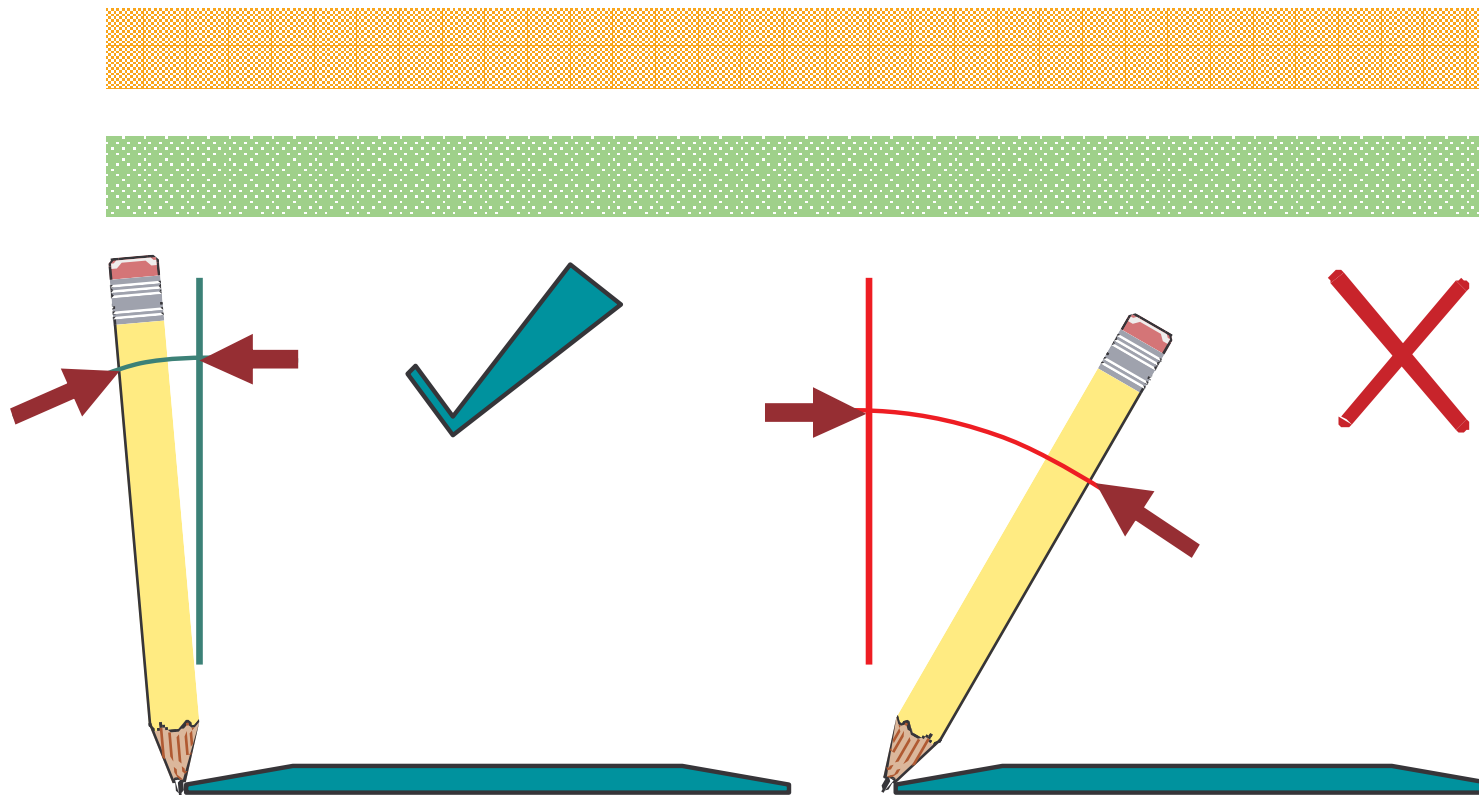

## TIPS

- Use the bevel edge downward for drawing lines using scales or set squares

– Not upward

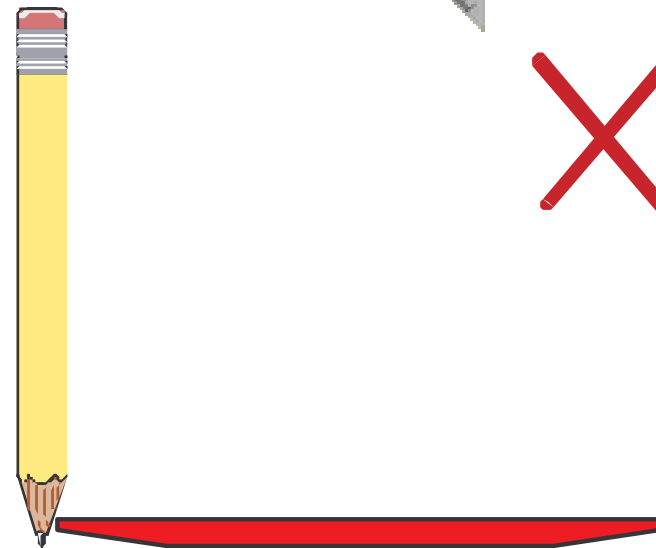
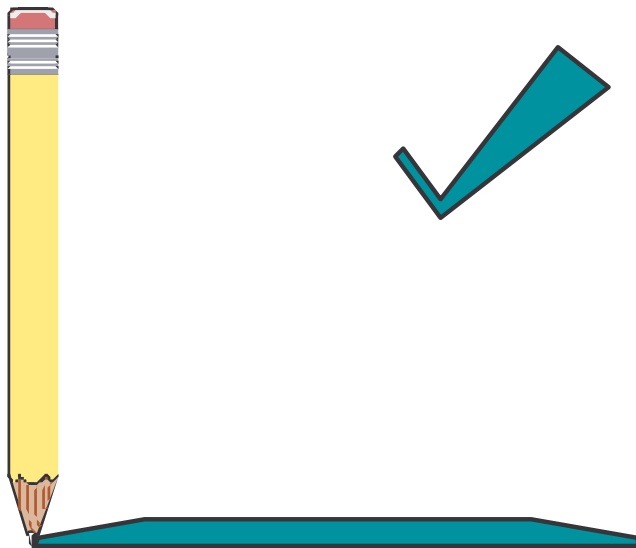
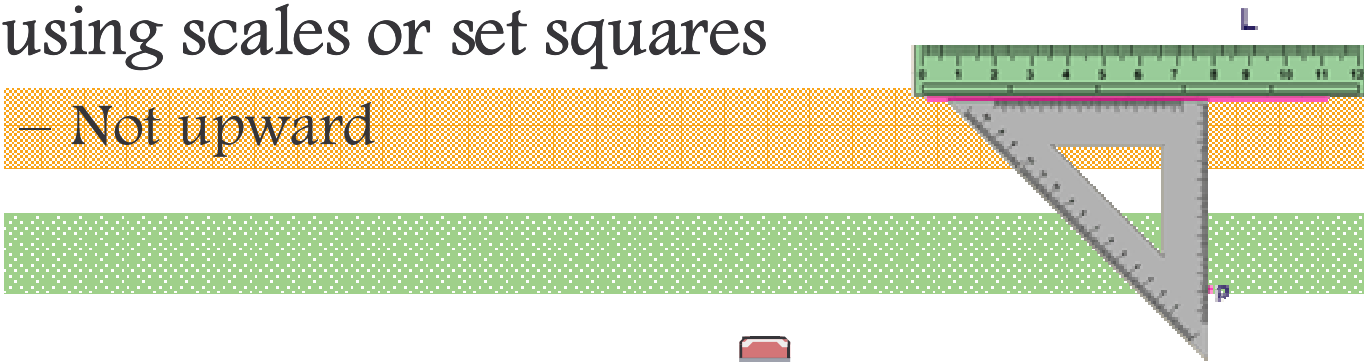

## TIPS

- Keep an acute angle between paper and pencil

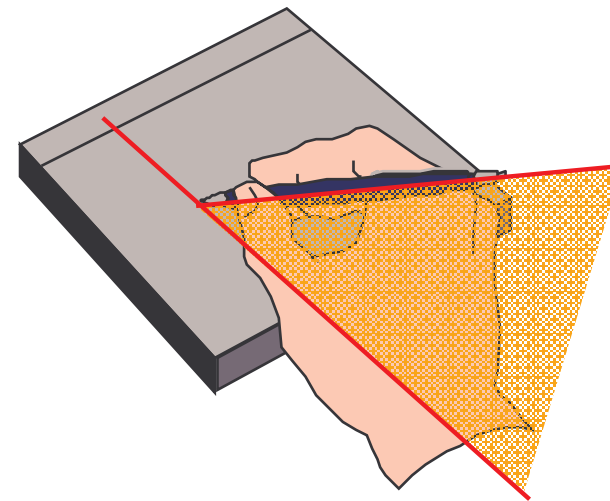
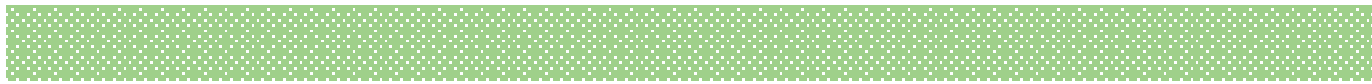
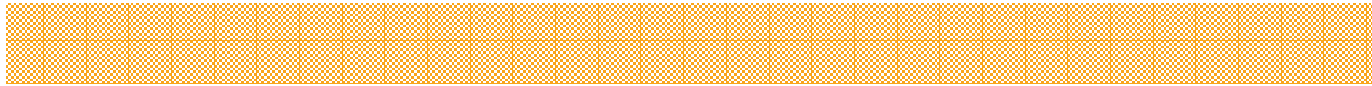

- Stroke the pencil in the acute angle direction
  - This will save the paper from tearing

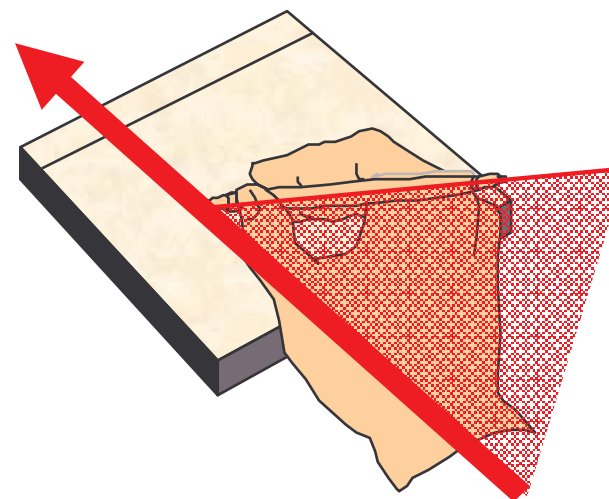
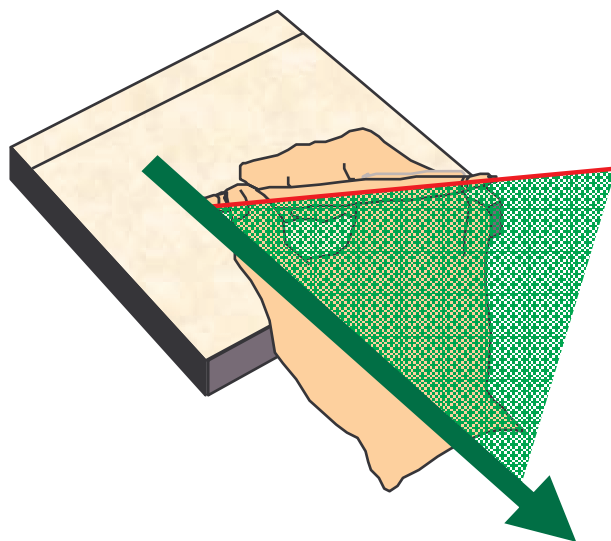



- Use pencils on all occasions of writing  
... in LIFE!!

– Write notes in all classes with pencils !!

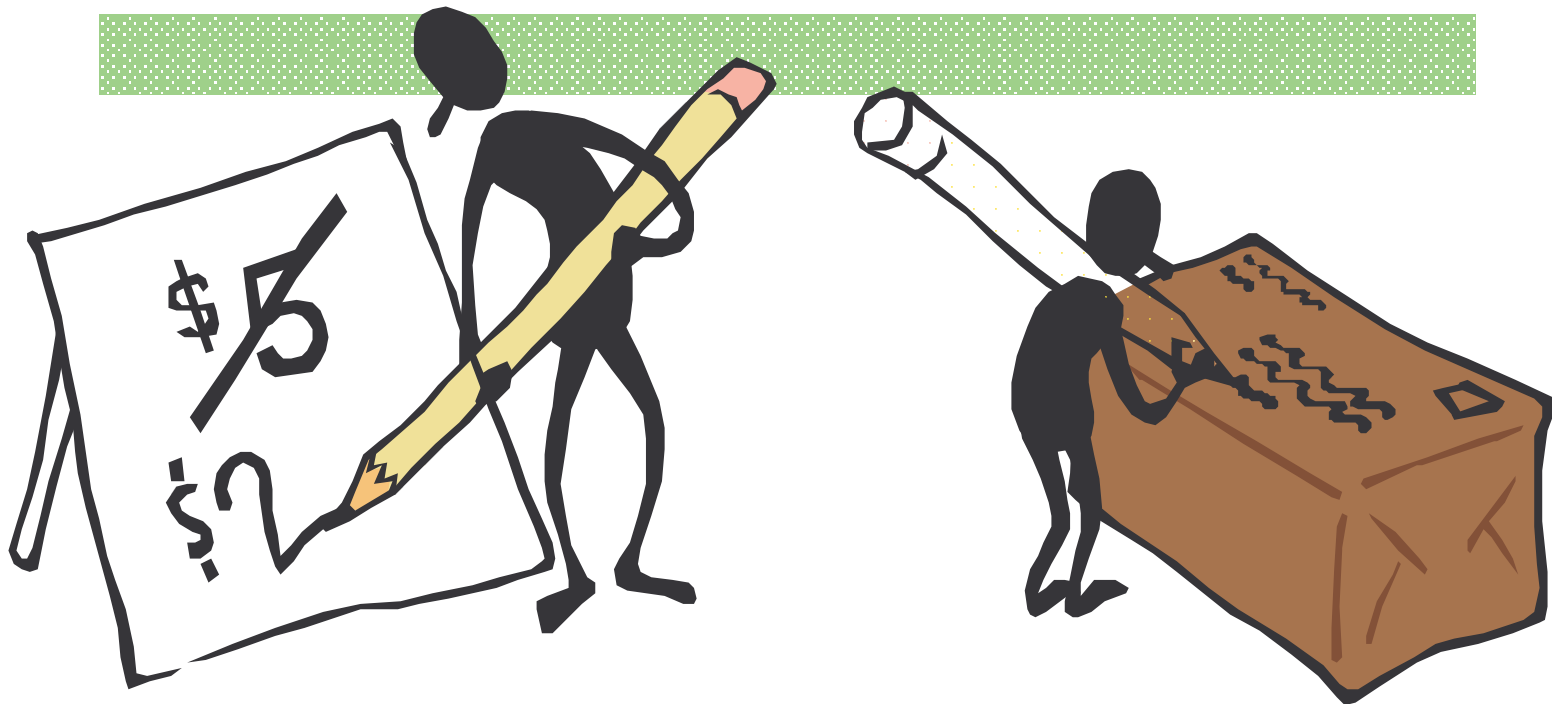

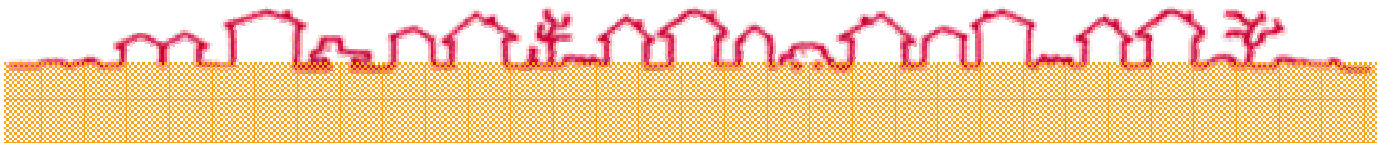

Have a Great Day!!

